

June 24/2012
No. 0001401



EB/L/HA/629

EBONYI STATE OF NIGERIA

No. 10
A/SUR/NOT/31/8/2012/EB 29
Vol. 219
PAGE 10

Certificate of Occupancy

LDR No:.....

File No: GAL/425

This is to certify that **OGBONNIA NGOZI ANTHONIA** of **NDUBIA IGBEAGU, IZZI EBONYI STATE**. (hereinafter called the holder/holders) is/are granted a right of occupancy in respect of **PROPERTY KNOWN AS PLOT 72 MGBABOR ECHARA LAYOUT ABAKALIKI IN EBONYI L.G.A EBONYI STATE**. described in the Schedule and more particularly marked and delineated in the **PLAN NO. EB 146** attached to this certificate and thereon bordered or verged **RED** for the term of **99 (NINETY-NINE)** year(s) from the **1ST JANUARY, 2012** subject to the provision of the **LAND USE ACT, 1978** and to the provisions and conditions implied by virtue of the said Act and the Regulations for the time being in force made under the said Act and to the covenants and conditions herein contained.

- 1(a) RENT: **N890.00 (EIGHT HUNDRED AND NINETY NAIRA)** per annum.
- (b) The rent hereby reserved shall be revised at the end of every **5 (FIVE)** year(s) of the term of this grant.
- (c) Buildings to the value of not less than **N1,000,000.00 (ONE MILLION NAIRA)** to the satisfaction and in accordance with plans approved by the **A.P.A** or such officer as the **A.P.A** may appoint.
- (d) Time within which such building(s) is/are to be erected and completed fit for occupation and use. Within **3 (THREE)** year(s) from the date of commencement of the term of this certificate.
- (e) Purpose for which the land granted may be used: **RESIDENTIAL**

2. This certificate of occupancy is issued subject to the following Covenants and conditions being observed by the holder/holders:-

- (a) Not to erect or build or permit to be erected or built on the land hereby granted any buildings other than those covenanted to be erected by virtue of this certificate of occupancy and the regulations under the said Act not to make or permit to be made any addition or alteration to the said buildings to be erected except in accordance with plans and specification approved by the **A.P.A** of Ebonyi State of Nigeria or any other officer appointed by him.
- (b) To keep the exterior and interior of the buildings to be erected and the outbuilding and erections which may at any time during the term hereby created be erected on the land hereby granted and all additions to such buildings and outbuildings and the walls, fences and appurtenances thereof in good and tenantable repair and condition.
- (c) Not to use the building on the said land whether now erected hereafter thereon for any purpose other than
- (d) Not to alienate the right of Certificate of Occupancy hereby granted or any part thereof by sale, assignment, mortgage, transfer of possession, sublease, or bequest or otherwise howsoever without the consent of the **GOVERNOR** first had and obtained.
- (e) Not to permit anything to be used or done upon any part of the granted premises which shall be noxious, noisy or offensive or be of any inconvenience or annoyance to tenants or occupiers of premises adjoining or near thereto.
- (f) To maintain standards of accommodation and sanitary and living conditions conformable with standards obtaining in the neighbourhood.
- (g) To pay forthwith with or without demand to the **DEPUTY DIRECTOR LAND** or other persons appointed by him before the issue of this certificate, all survey fees, registration fees, and other charges due in respect of preparation and issue and registration of this certificate.
- (h) Paid an improvement premium of **N22,249.00 (TWENTY-TWO THOUSAND TWO HUNDRED AND FORTY- NINE NAIRA)**
- (i) To install and operate water borne sewage system within six months from the date the buildings erected on the plot are connected to piped water-supply.
- (j) To pay with or without demand on the first day of January of each year the rent reserved in these presents or any other rent as may be revised in future.

27/3/2012

GIVEN under my hand this 26th day of May 2012

ARC. NWOGHA FRIDAY MOSES

COMMISSIONER FOR LANDS, SURVEY AND HOUSING EBONYI STATE OF NIGERIA

(By virtue of Powers to grant Certificate of Occupancy and Right of Occupancy delegated to him by the Governor, under Section 4(a) and (b) of the Land Use Edict (now Law) N0.2 of 1979 (as applicable in Ebonyi State), and Section 45 of the Land Use Act No.6 of 1978.

Signature of Holder / Holders Signature of Witness

Name of Witness Nwoie B. u Occupation of Witness Civil Service

Address Min. of Lands, Survey and Housing Abakaliki



Title Holder: OGBONNIA NGOZI ANTHONIA

Old File Number: EB/L/LAI/629 New File Number: GAL/425

Survey Plan No: EB 146

Property Description: PROPERTY KNOWN AS PLOT 72 MGBABOR ECHARA LAYOUT ABAKALIKI IN EBONYI L.G.A EBONYI STATE.

NIGERIA
One Hundred Naira
STAMP DUTIES

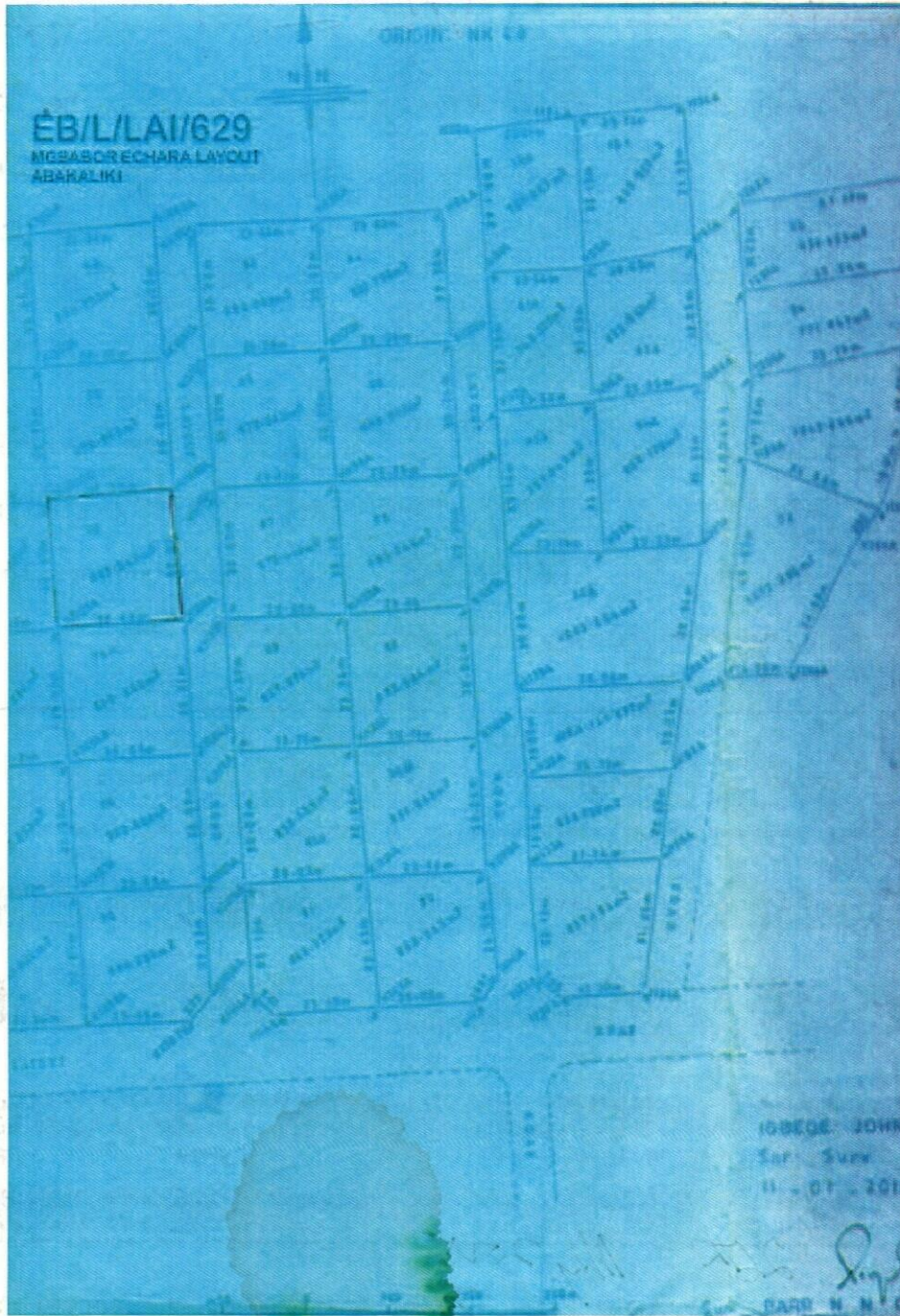

The within instrument in the opinion of the commissioner of stamp duties chargeable with the sum of N100.00 and the duty thereon has been assessed accordingly.

(Sgd) OGBONNIA, M-O
Commissioner For Stamp Duties
RCR NO 0066214 OF 02/02/2011

This instrument was delivered for registration at 8:53 O'Clock in the FORENOON on 7th June, 2012 and registered as No 10 at page 10 Volume 219 of the Ministry of Lands Registry in the Office at Abakaliki

(Sgd) [Signature]
Registrar of Deeds

VERIFY TRUE COPY
(Sgd) E.A. Aw...
REGISTRAR OF DEEDS
15/01/2012





EBONYI LANDS INFORMATION MANAGEMENT SYSTEM



SURVEY DESCRIPTION OF LANDED PROPERTY OF GAL/425

OGBONNIA NGOZI ANTHONIA

All that parcel of land at PLOT 72 MGBABOR LAYOUT in the EBONYI

Local Government Area of the Ebonyi State of Nigeria, containing an Area of approximately

889.947

Square Metres shown on Ebonyi State of Nigeria Survey Plan No.

EB 146

(Tracing No. EB 296)

) the

boundaries of which are described below.

Starting at concrete pillar marked K 1094A the coordinates of which are:

523.106

Metres South and

2331.280

Metres West of a concrete pillar marked

NK 48

the origin of ABAKALIKI

cadastral surveys. The boundaries run

in straight lines the bearings and length of which are as follows:

S/N	From	Bearing		Lengths in: M		To
		Degree (°)	Minute (')	Length		
	PBK 1094A	84	17'51"	30.20		PBK 1082A
	PBK 1082A	175	07'29"	30.03		PBK 1083A
	PBK 1083A	266	11'27"	30.08		PBK 1095A
	PBK 1095A	354	52'05"	29.03		PBK 1094A
		THE	STARTING	POINT		

All property beacons are concrete pillars, all bearing and length approximate and all bearings are referred to National /True North.

Topolope

For Surveyor-General
Ebonyi State of Nigeria
