

oct/31/12

No 0001757

No. 49

EBONYI STATE OF NIGERIA

GAL/583
PAGE 49
EB/L/LA/29B

Adsur/No/352/12/2014/EB85

Certificate of Occupancy

LDR No:.....

File No: GAL/533

This is to certify that **NKECHINYERE AMU** of **NO 3 NIBO STREET, ABAKALIKI**. (hereinafter called the holder/holders) is/are granted a right of occupancy in respect of **LAND KNOWN AS PLOT 246 GRA NKALEKE, ABAKALIKI LOCAL GOVERNMENT AREA EBONYI STATE** described in the Schedule and more particularly marked and delineated in the **PLAN NO. EB/117B** attached to this certificate and thereon bordered or verged **RED** for the term of **99 (NINETY-NINE)** year(s) from the **1ST JANUARY, 2012** subject to the provision of the **LAND USE ACT, 1978** and to the provisions and conditions implied by virtue of the said Act and the Regulations for the time being in force made under the said Act and to the covenants and conditions herein contained.

- 1(a) **RENT: N590.15 (FIVE HUNDRED AND NINETY NAIRA, FIFTEEN KOBO)** per annum.
- (b) The rent hereby reserved shall be revised at the end of every **5 (FIVE)** year(s) of the term of this grant.
- (c) Buildings to the value of not less than **N1000,000.00 (ONE MILLION NAIRA)** to the satisfaction and in accordance with plans approved by the **A.P.A** or such officer as the **A.P.A** may appoint.
- (d) Time within which such building(s) is/are to be erected and completed fit for occupation and use. Within **3 (THREE)** year(s) from the date of commencement of the term of this certificate.
- (e) Purpose for which the land granted may be used: **RESIDENTIAL**

2. This certificate of occupancy is issued subject to the following Covenants and conditions being observed by the holder/holders:-

- (a) Not to erect or build or permit to be erected or built on the land hereby granted any buildings other than those covenanted to be erected by virtue of this certificate of occupancy and the regulations under the said Act not to make or permit to be made any addition or alteration to the said buildings to be erected except in accordance with plans and specification approved by the **A.P.A** of Ebonyi State of Nigeria or any other officer appointed by him.
- (b) To keep the exterior and interior of the buildings to be erected and the outbuilding and erections which may at any time during the term hereby created be erected on the land hereby granted and all additions to such buildings and outbuildings and the walls, fences and appurtenances thereof in good and tenable repair and condition.
- (c) Not to use the building on the said land whether now erected or to be erected hereafter thereon for any purpose other than that specified in these presents.
- (d) Not to alienate the right of Certificate of Occupancy hereby granted or any part thereof by sale, assignment, mortgage, transfer of possession, sublease, or bequest or otherwise howsoever without the consent of the **GOVERNOR** first had and obtained.
- (e) Not to permit anything to be used or done upon any part of the granted premises which shall be noxious, noisy or offensive or be of any inconvenience or annoyance to tenants or occupiers of premises adjoining or near thereto.
- (f) To maintain standards of accommodation and sanitary and living conditions conformable with standards obtaining in the neighbourhood.
- (g) To pay forthwith with or without demand to the **DIRECTOR LANDS** or other persons appointed by him before the issue of this certificate, all survey fees, registration fees, and other charges due in respect of preparation and issue and registration of this certificate.
- (h) Paid an improvement premium of **N14,755.00 (FORTEEN THOUSAND SEVEN HUNDRED AND FIFTY FIVE NAIRA)**
- (i) To install and operate water borne sewage system within six months from the date the buildings erected on the plot are connected to piped water-supply.
- (j) To pay with or without demand on the first day of January of each year the rent reserved in these presents or any other rent as may be revised in future.

5/10/15
28/8/15

GIVEN under my hand this 29th day of August, 2014

ARC. NWOGHA FRIDAY MOSES

COMMISSIONER FOR LANDS, SURVEY AND HOUSING EBONYI STATE OF NIGERIA

(By virtue of Powers to grant Certificate of Occupancy and Right of Occupancy delegated to him by the Governor, under Section 4(a) and (b) of the Land Use Edict (now Law) N0.2 of 1979 (as applicable in Ebonyi State), and Section 45 of the Land Use Act No.6 of 1978.

Signature of Holder / Holders Signature of Witness

Name of Witness UGBALA SUNDAY J Occupation of Witness CIVIL SERVICE

Address MINISTRY OF LANDS, SURVEY AND HOUSING, ABAKALIKI

28/8/15



Title Holder: NKECHINYERE AMU

Old File Number: EB/L/LAI/293 New File Number: GAL/533

Survey Plan No: EB/117B

Property Description: LAND KNOWN AS PLOT 246 GRA NKALEKE, ABAKALIKI LOCAL GOVERNMENT AREA EBONYI STATE

NIGERIA
one hundred alone
STAMP DUTIES

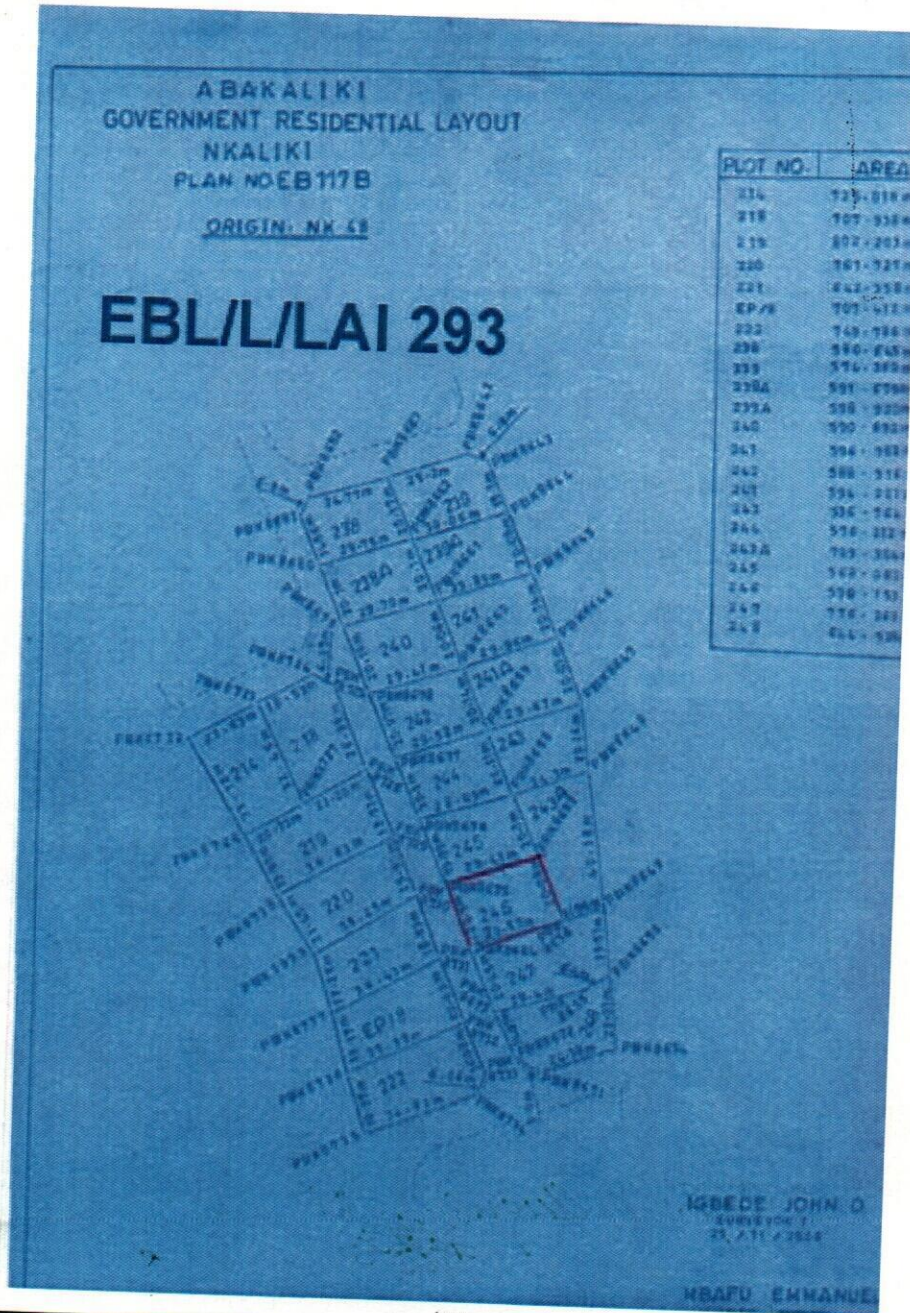

The within instrument in the opinion of the commissioner of stamp duties chargeable with the sum of N100.00 and the duty thereon has been assessed accordingly.

Sgt/John M. O.
Commissioner For Stamp Duties
093372OF27/5/11

This instrument was delivered for registration at 12:57 O'Clock in the AFTERNOON on 3rd October, 2012 and registered as No 49 at page 49 Volume 231 of the Ministry of Lands Registry in the Office at Abakaliki



[Signature]
Registrar of Deeds

CERTIFY TRUE COPY
[Signature]
REGISTRAR OF DEEDS





EBONYI LANDS INFORMATION MANAGEMENT SYSTEM



SURVEY DESCRIPTION OF LANDED PROPERTY OF

PLOT 246 NKALEKE G.R.A ABAKALIKI LOCAL GOVT. AREA

All that parcel of land at PLOT 246 NKALEKE GRA in the ABAKALIKI

Local Government Area of the Ebonyi State of Nigeria, containing an Area of approximately 590.153 Square Meters shown on Ebonyi State of Nigeria

Survey Plan No. EB 117 B (Tracing No: EB - 280) the boundaries of which are described below.

Starting at concrete pillar marked PB K8674 the coordinates of which are: 1167.866 Meters South and 947.170 Meter West of a concrete pillar marked NK 48 the Origin of ABAKALIKI Cadastral surveys.

The boundaries run in straight lines the bearings and lengths of which are as follows:

S/N	From	Bearing		Lengths in: M	
		Degree(°)	Minute(')	Length	To
	PBK 8674	335°	24' 55"	20.29m	PBK 8675
	PBK 8675	70°	56' 39"	29.41m	PBK 8657
	PBK 8657	154°	51' 27"	20.09m	PBK 8656
	PBK 8656	252°	29' 53"	29.57m	PBK 8674



THE STARTING POINT

All property beacons are concrete pillars, all bearings and lengths approximate and all bearings are referred to National/True North.

[Handwritten Signature]

**For Surveyor-General
Ebonyi State of Nigeria**
