

Mum/59/013

Nº 0001863



EB/L/LA1/624#1

EBONYI STATE OF NIGERIA

No. 63

Vol: 243

Page 63

Certificate of Occupancy

LDR No:.....

File No: GAL/602

This is to certify that PRINCE ALEXANDER ELOM of EZZA ROAD NORTH EXTENTION LAYOUT ABAKALIKI, EBONYI STATE (hereinafter called the holder/holders) is/are granted a right of occupancy in respect of PLOT EP/1 EZZA ROAD NORTH EXTENTION LAYOUT ABAKALIKI, EBONYI STATE described in the Schedule and more particularly marked and delineated in the PLAN NO. EB-214 attached to this certificate and thereon bordered or verged RED for the term of 99 (NINETY-NINE) year(s) from the 1ST JANUARY, 2013 subject to the provision of the LAND USE ACT, 1978 and to the provisions and conditions implied by virtue of the said Act and the Regulations for the time being in force made under the said Act and to the covenants and conditions herein contained.

- 1(a) RENT: N2,744.00 (TWO THOUSAND SEVEN HUNDRED AND FORTY FOUR NAIRA) per annum.
- (b) The rent hereby reserved shall be revised at the end of every 5 (FIVE) year(s) of the term of this grant.
- (c) Buildings to the value of not less than N1,000,000.00 (ONE MILLION NAIRA) to the satisfaction and in accordance with plans approved by the A.P.A or such officer as the A.P.A may appoint.
- (d) Time within which such building(s) is/are to be erected and completed fit for occupation and use. Within 3 (THREE) year(s) from the date of commencement of the term of this certificate.
- (e) Purpose for which the land granted may be used: RESIDENTIAL

- 2. This certificate of occupancy is issued subject to the following Covenants and conditions being observed by the holder/holders:-
 - (a) Not to erect or build or permit to be erected or built on the land hereby granted any buildings other than those covenanted to be erected by virtue of this certificate of occupancy and the regulations under the said Act not to make or permit to be made any addition or alteration to the said buildings to be erected except in accordance with plans and specification approved by the A.P.A of Ebonyi State of Nigeria or any other officer appointed by him.
 - (b) To keep the exterior and interior of the buildings to be erected and the outbuilding and erections which may at any time during the term hereby created be erected on the land hereby granted and all additions to such buildings and outbuildings and the walls, fences and appurtenances thereof in good and tenatable repair and condition.
 - (c) Not to use the building on the said land whether now erected or to be erected hereafter thereon for any purpose other than that specified in these presents.
 - (d) Not to alienate the right of Certificate of Occupancy hereby granted or any part thereof by sale, assignment, mortgage, transfer of possession, sublease, or bequest or otherwise howsoever without the consent of the GOVERNOR first had and obtained.
 - (e) Not to permit anything to be used or done upon any part of the granted premises which shall be noxious, noisy or offensive or be of any inconvenience or annoyance to tenants or occupiers of premises adjoining or near thereto.
 - (f) To maintain standards of accommodation and sanitary and living conditions conformable with standards obtaining in the neighbourhood.
 - (g) To pay forthwith with or without demand to the DIRECTOR LANDS or other persons appointed by him before the issue of this certificate, all survey fees, registration fees, and other charges due in respect of preparation and issue and registration of this certificate.
 - (h) Paid an improvement premium of N68,591.00 (SIXTY EIGHT THOUSAND FIVE HUNDRED AND NINETY ONE NAIRA)
 - (i) To install and operate water borne sewage system within six months from the date the buildings erected on the plot are connected to piped water-supply.
 - (j) To pay with or without demand on the first day of January of each year the rent reserved in these presents or any other rent as may be revised in future.

GIVEN under my hand this 13th day of March 2013

ARC. NWOGHA FRIDAY MOSES
COMMISSIONER FOR LANDS, SURVEY AND HOUSING EBONYI STATE OF NIGERIA

(By virtue of Powers to grant Certificate of Occupancy and Right of Occupancy delegated to him by the Governor, under Section 4(a) and (b) of the Land Use Edict (now Law) NO.2 of 1979 (as applicable in Ebonyi State), and Section 45 of the Land Use Act No.6 of 1978.

Signature of Holder / Holders Signature of Witness

Name of Witness UGWUMBA RITA Occupation of Witness CIVIL SERVANT

Address MINISTRY OF LANDS SURVEY AND HOUSING ABAKALIKI

14/3/13



Title Holder: PRINCE ALEXANDER ELOM

Old File Number: EB/L/LAI/621A New File Number: GAL/602

Survey Plan No: EB-214

Property Description: PLOT EP/1 EZZA ROAD NORTH EXTENTION LAYOUT
ABAKALIKI, EBONYI STATE

ONE HUNDRED Naira

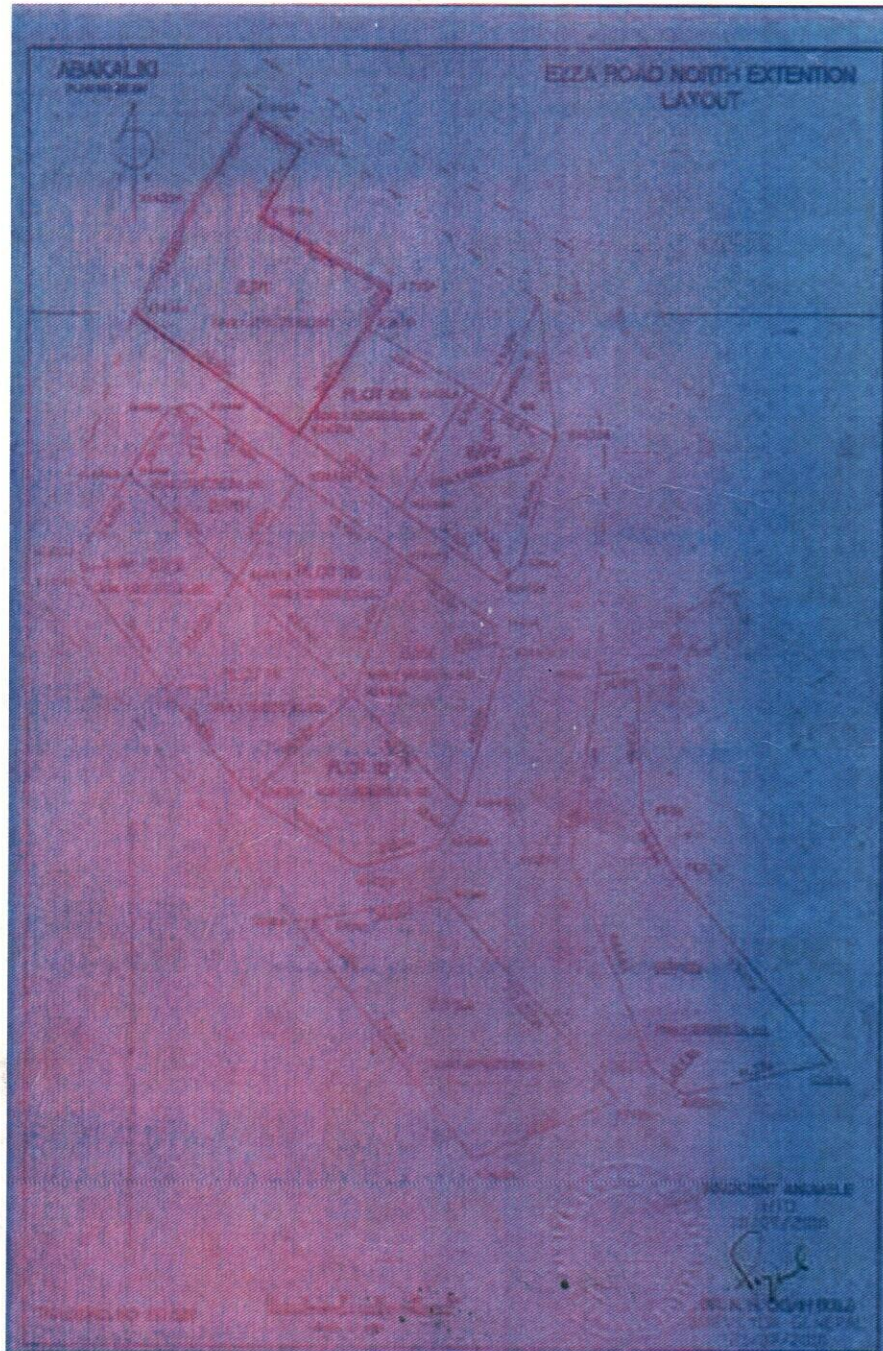

The within instrument in the opinion of the commissioner of stamp duties chargeable with the sum of N100.00 and the duty thereon has been assessed accordingly.

(sgd) Obasi B-D
Commissioner For Stamp Duties
RCR NO 0198393

This instrument was delivered for registration at 12:30 O'Clock in the AFTERNOON on 11th March, 2013 and registered as No 63 at page 63 Volume 243 of the Ministry of Lands Registry in the Office at Abakaliki

Registrar of Deeds

CERTIFIED COPY
REGISTRAR OF DEEDS

Handwritten signature or initials.



15/3/13



EBONYI LANDS INFORMATION MANAGEMENT SYSTEM



SURVEY DESCRIPTION OF LANDED PROPERTY OF GAL/602

PRINCE ALEXANDER ELOM

PLOT EP/1 EZZA ROAD NORTH

All that parcel of land at **EXTENTION LAYOUT ABAKALIKI** in the **ABAKALIKI**

Local Government Area of the Ebonyi State of Nigeria, containing an Area of approximately

2.743.657 Square Metres shown on Ebonyi State of Nigeria Survey Plan No.

EB-214

(Tracing No. **EB-388**) the

boundaries of which are described below.

Starting at concrete pillar marked **K 1515A** the coordinates of which are:

803.953 Metres South and **164.039** Metres West of a concrete pillar marked

NK 48 the origin of **ABAKALIKI** cadastral surveys. The boundaries run

in straight lines the bearings and length of which are as follows:

S/N	From	Bearing		Lengths in: M	
		Degree (°)	Minute (')	Length	To
	PBK 1515A	214	14	12.09	PBK 3078
	PBK 3078	212	33	33.47	PBK 1435A
	PBK 1435A	305	19	55.05	PBK 1434A
	PBK 1434A	29	02	34.06	PBK 1433A
	PBK 1433A	34	04	27.31	PBK 1466A
	PBK 1466A	123	02	16.73	PBK 7155
	PBK 7155	212	32	20.97	PBK 1514
	PBK 1514	118	40	40.07	PBK 1515

THE STARTING POINT

All property beacons are concrete pillars, all bearing and length approximate and all bearings are referred to National /True North.

[Handwritten Signature]

FOR SURVEYOR - GENERAL
EBONYI STATE OF NIGERIA
