

Nº 0000217



EBONYI STATE OF NIGERIA

EBS/LU/AI/1491

Jan/31/11 No. 10 Vol: 133 PAGE 10

Certificate of Occupancy

LDR No:.....

File No: PAL/160

This is to certify that **CHIMEZIE BETHEL OKOLI** of **NO 3 ACHI STREET** (hereinafter called the holder/holders) is/are granted a right of occupancy in respect of **LAND AT UNAGBOKE INYIMAGU IZZI** described in the Schedule and more particularly marked and delineated in the **PLAN NO. OTE/EB 994/2009** attached to this certificate and thereon bordered or verged **RED** for the term of **99 (NINETY-NINE)** year(s) from the **1ST JANUARY, 2010** subject to the provision of the **LAND USE ACT, 1978** and to the provisions and conditions implied by virtue of the said Act and the Regulations for the time being in force made under the said Act and to the covenants and conditions herein contained.

- 1(a) **RENT: N950.00 (NINE HUNDRED AND FIFTY NAIRA)** per annum.
- (b) The rent hereby reserved shall be revised at the end of every **5 (FIVE)** year(s) of the term of this grant.
- (c) Buildings to the value of not less than **N1,000,000.00 (ONE MILLION NAIRA)** to the satisfaction and in accordance with plans approved by the **A.P.A** or such officer as the **A.P.A** may appoint.
- (d) Time within which such building(s) is/are to be erected and completed fit for occupation and use. Within **3 (THREE)** year(s) from the date of commencement of the term of this certificate.
- (e) Purpose for which the land granted may be used: **RESIDENTIAL**

2. This certificate of occupancy is issued subject to the following Covenants and conditions being observed by the holder/holders:-

- (a) Not to erect or build or permit to be erected or built on the land hereby granted any buildings other than those covenanted to be erected by virtue of this certificate of occupancy and the regulations under the said Act not to make or permit to be made any addition or alteration to the said buildings to be erected except in accordance with plans and specification approved by the **A.P.A** of Ebonyi State of Nigeria or any other officer appointed by him.
- (b) To keep the exterior and interior of the buildings to be erected and the outbuilding and erections which may at any time during the term hereby created be erected on the land hereby granted and all additions to such buildings and outbuildings and the walls, fences and appurtenances thereof in good and tenable repair and condition.
- (c) Not to use the building on the said land whether now erected hereafter thereon for any purpose other than
- (d) Not to alienate the right of Certificate of Occupancy hereby granted or any part thereof by sale, assignment, mortgage, transfer of possession, sublease, or bequest or otherwise howsoever without the consent of the **GOVERNOR** first had and obtained.
- (e) Not to permit anything to be used or done upon any part of the granted premises which shall be noxious, noisy or offensive or be of any inconvenience or annoyance to tenants or occupiers of premises adjoining or near thereto.
- (f) To maintain standards of accommodation and sanitary and living conditions conformable with standards obtaining in the neighbourhood.
- (g) To pay forthwith with or without demand to the **DEPUTY DIRECTOR LAND** or other persons appointed by him before the issue of this certificate, all survey fees, registration fees, and other charges due in respect of preparation and issue and registration of this certificate.
- (h) Paid an improvement premium of **N0.00 (N/A)**
- (i) To install and operate water borne sewage system within six months from the date the buildings erected on the plot are connected to piped water-supply.
- (j) To pay with or without demand on the first day of January of each year the rent reserved in these presents or any other rent as may be revised in future.

GIVEN under my hand this.....day of.....

14th March 2011

COMRADE JONAH EGBA

COMMISSIONER FOR LANDS, SURVEY AND HOUSING EBONYI STATE OF NIGERIA

(By virtue of Powers to grant Certificate of Occupancy and Right of Occupancy delegated to him by the Governor, under Section 4(a) and (b) of the Land Use Edict (now Law) No.2 of 1979 (as applicable in Ebonyi State), and Section 45 of the Land Use Act No.6 of 1978.

Signature of Holder / Holders Signature of Witness

Name of Witness Occupation of Witness

Address



11/01/11

15/07/11

NIGERIA
One hundred
STAMP DUTIES

Title Holder: CHIMEZIE BETHEL OKOLI

Old File Number: EBS/LU/AI/1491 **New File Number:** PAL/160

Survey Plan No: OTE/EB 994/2009

Property Description: LAND AT UNAGBOKE INYIMAGU IZZI

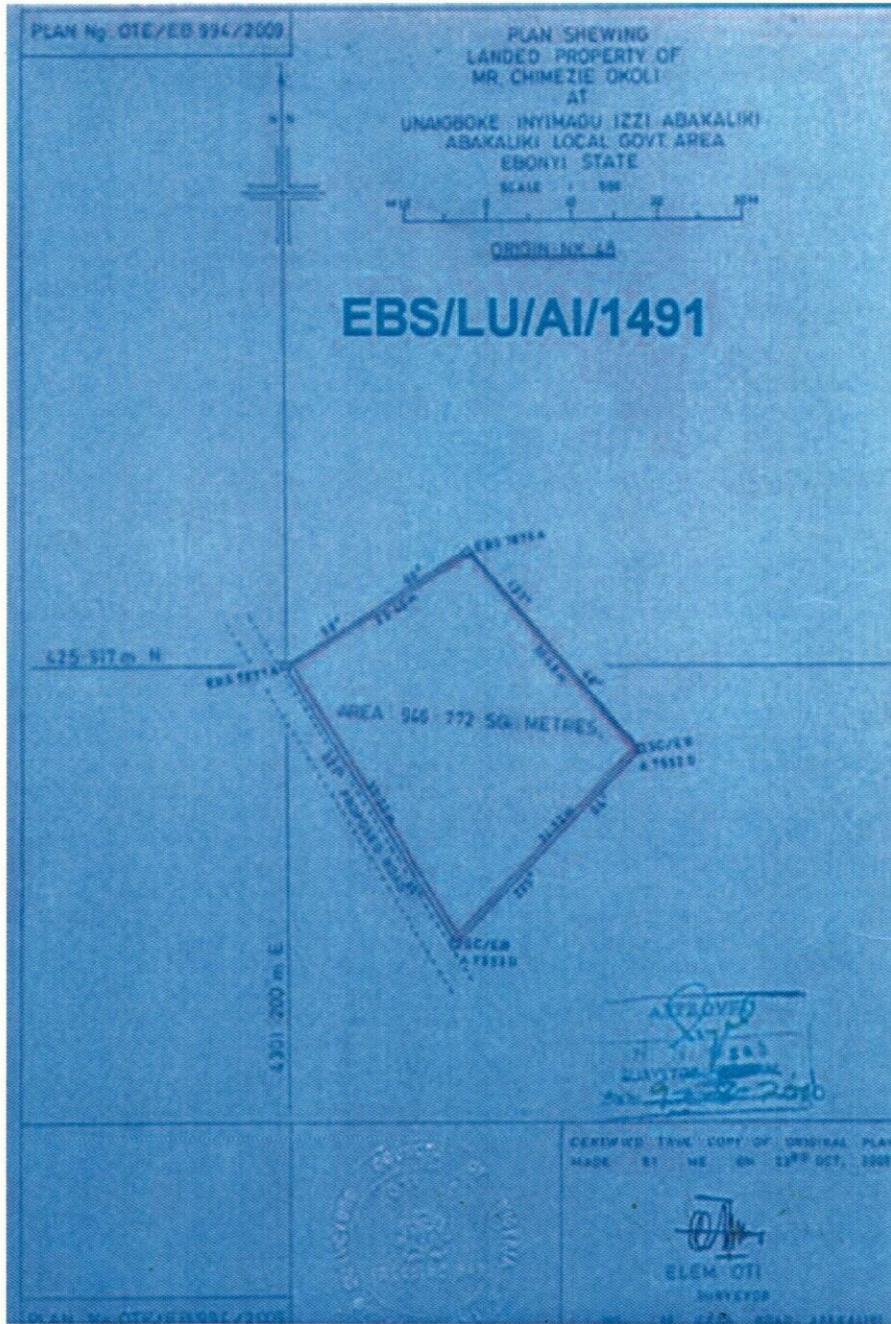
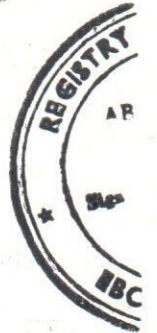

The within instrument in the opinion of the commissioner of stamp duties chargeable with the sum of N100.00 and the duty thereon has been assessed accordingly.

(Sgd) Obasi B...
Commissioner For Stamp Duties
 (029021) of 10/8/2010

This instrument was delivered for registration at 12:30 O'Clock in the **AFTERNOON** on **4th January, 2011** and registered as No 10 at page 10 Volume 133 of the Ministry of Lands Registry in the Office at Abakaliki

[Signature]
Registrar of Deeds

CERTIFIED TRUE COPY
[Signature]
REGISTRAR OF DEEDS



PAL / 160
 616101



EBONYI LANDS INFORMATION MANAGEMENT SYSTEM

SURVEY DESCRIPTION OF LANDED PROPERTY OF PAL/160

MR CHIMEZIE OKOLI

UNAAGBOKE INYIMAGU IZZI

in the ABAKALIKI

All that parcel of land at _____

Local Government Area of the Ebonyi State of Nigeria, containing an Area of approximately

946.772 Square Metres shown on Ebonyi State of Nigeria Survey Plan No.OTE/EB994/2009 (Tracing No. _____) the

boundaries of which are described below.

Starting at concrete pillar marked **EBS7877A** the coordinates of which are:**425.917** Metres North and **4301.200** Metres East of a concrete pillar marked**NK- 48** the origin of **ABAKALIKI** cadastral surveys. The boundaries run

in straight lines the bearings and length of which are as follows:

S/N	From	Bearing		Lengths in: M	
		Degree (°)	Minute (')	Length	To
	EBS 7877A	58	03	25.40	EBS7876A
	EBS7879A	137	48	30.48	SC-EBA 7552D
	SC-EBA7552	225	04	31032	SC-EBA7553D
	SC-EBA7553D	327	35	37.02	EBS 7877A

All property beacons are concrete pillars, all bearing and length approximate and all bearings are referred to National /True North.

[Signature]
For Surveyor-General

Ebonyi State of Nigeria
