

Nº 0000831



EBONYI STATE OF NIGERIA

Dec/86/011

EBS/LU/A/1882

Certificate of Occupancy

LDR No:.....

NO. 75

Vol: 176

PAGE 75

File No: PAL/1906

This is to certify that CHIDOZIE IGWE of NO 1 ABOMEGE CLOSE, OFF NNOROM, NTEZI ABBA (hereinafter called the holder/holders) is/are granted a right of occupancy in respect of LAND AT NTEZI-ABA IN EBONYI L.G.A EBONYI STATE. described in the Schedule and more particularly marked and delineated in the PLAN NO. DA/EB 266/2010 attached to this certificate and thereon bordered or verged RED for the term of 99 (NINETY-NINE) year(s) from the 1ST JANUARY, 2011 subject to the provision of the LAND USE ACT, 1978 and to the provisions and conditions implied by virtue of the said Act and the Regulations for the time being in force made under the said Act and to the covenants and conditions herein contained.

- 1(a) RENT: N935.00 (NINE HUNDRED AND THIRTY-FIVE NAIRA) per annum.
- (b) The rent hereby reserved shall be revised at the end of every 5 (FIVE) year(s) of the term of this grant.
- (c) Buildings to the value of not less than N1,000,000.00 (ONE MILLION NAIRA) to the satisfaction and in accordance with plans approved by the A.P.A or such officer as the A.P.A may appoint.
- (d) Time within which such building(s) is/are to be erected and completed fit for occupation and use. Within 3 (THREE) year(s) from the date of commencement of the term of this certificate.
- (e) Purpose for which the land granted may be used: RESIDENTIAL

2. This certificate of occupancy is issued subject to the following Covenants and conditions being observed by the holder/holders:-

- (a) Not to erect or build or permit to be erected or built on the land hereby granted any buildings other than those covenanted to be erected by virtue of this certificate of occupancy and the regulations under the said Act not to make or permit to be made any addition or alteration to the said buildings to be erected except in accordance with plans and specification approved by the A.P.A of Ebonyi State of Nigeria or any other officer appointed by him.
- (b) To keep the exterior and interior of the buildings to be erected and the outbuilding and erections which may at any time during the term hereby created be erected on the land hereby granted and all additions to such buildings and outbuildings and the walls, fences and appurtenances thereof in good and tenable repair and condition.
- (c) Not to use the building on the said land whether now erected hereafter thereon for any purpose other than
- (d) Not to alienate the right of Certificate of Occupancy hereby granted or any part thereof by sale, assignment, mortgage, transfer of possession, sublease, or bequest or otherwise howsoever without the consent of the GOVERNOR first had and obtained.
- (e) Not to permit anything to be used or done upon any part of the granted premises which shall be noxious, noisy or offensive or be of any inconvenience or annoyance to tenants or occupiers of premises adjoining or near thereto.
- (f) To maintain standards of accommodation and sanitary and living conditions conformable with standards obtaining in the neighbourhood.
- (g) To pay forthwith with or without demand to the DEPUTY DIRECTOR LAND or other persons appointed by him before the issue of this certificate, all survey fees, registration fees, and other charges due in respect of preparation and issue and registration of this certificate.
- (h) Paid an improvement premium of N00.00 (N/A)
- (i) To install and operate water borne sewage system within six months from the date the buildings erected on the plot are connected to piped water-supply.
- (j) To pay with or without demand on the first day of January of each year the rent reserved in these presents or any other rent as may be revised in future.

Handwritten scribble on the left margin.

GIVEN under my hand this 21st day of Jan 2012

Handwritten signature of the Commissioner.

ARC. NWOGHA FRIDAY MOSES  
COMMISSIONER FOR LANDS, SURVEY AND HOUSING EBONYI STATE OF NIGERIA

(By virtue of Powers to grant Certificate of Occupancy and Right of Occupancy delegated to him by the Governor, under Section 4(a) and (b) of the Land Use Edict (now Law) No.2 of 1979 (as applicable in Ebonyi State), and Section 45 of the Land Use Act No.6 of 1978.

Signature of Holder / Holders ..... Signature of Witness .....

Name of Witness Nwoie B. U ..... Occupation of Witness Civil Servant .....

Address Min. of Lands, Survey and Housing Abakalika .....

28/2/12



Title Holder: CHIDOZIE IGWE

Old File Number: EBS/LU/AI/1882 New File Number: PAL/1906

Survey Plan No: DA/EB 266/2010

Property Description: LAND AT NTEZI-ABA IN EBONYI L.G.A EBONYI STATE.

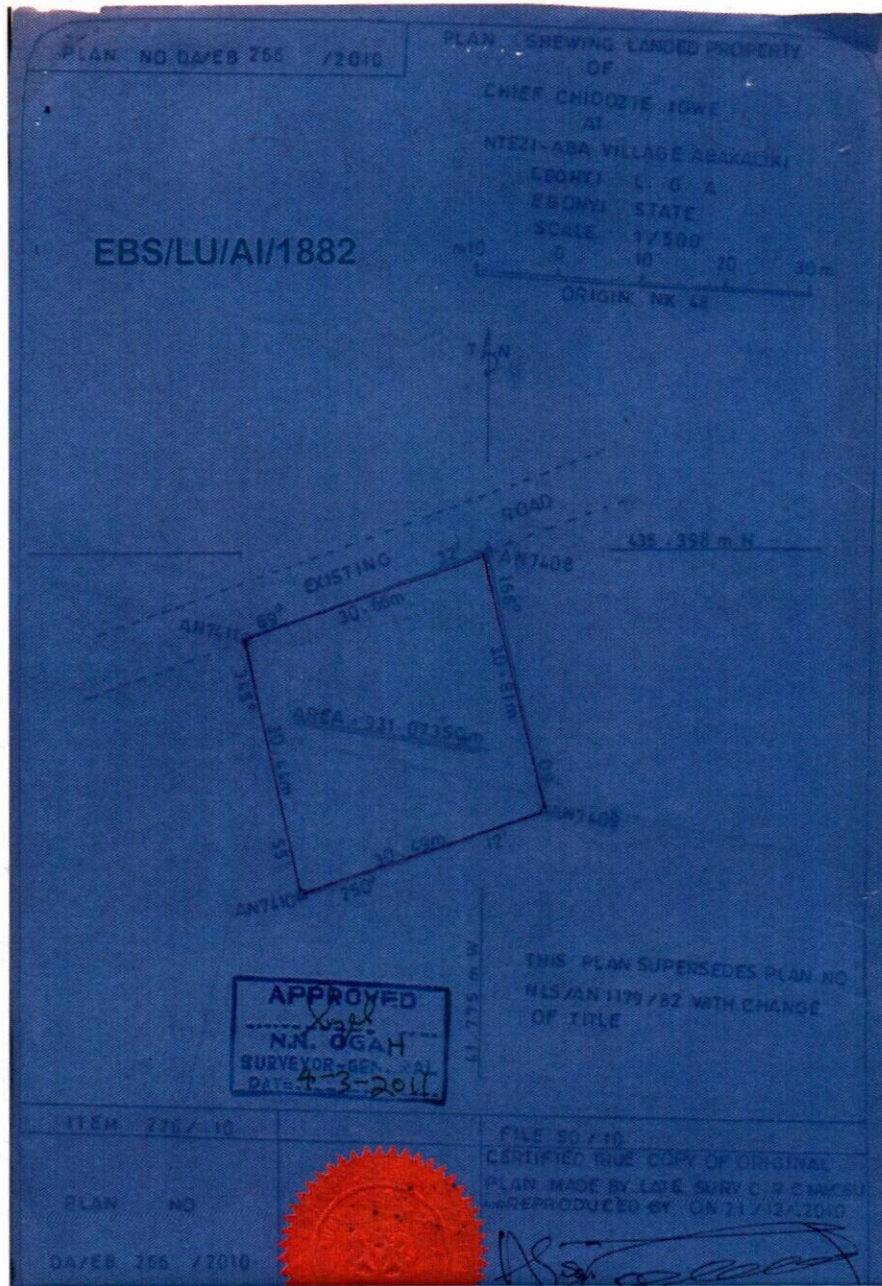

APPROVED  
N.N. OGAH  
SURVEYOR-GEN. AI  
DATE: 4-3-2011

THIS PLAN SUPERSEDES PLAN NO NLS/AN 1179/82 WITH CHANGE OF TITLE

The within instrument in the opinion of the commissioner of stamp duties chargeable with the sum of N100.00 and the duty thereon has been assessed accordingly.  
*(Sgd) OBASI B-O*  
Commissioner For Stamp Duties  
0084524 OF 12/5/011

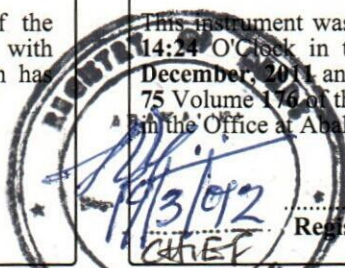

This instrument was delivered for registration at 14:24 O'clock in the AFTERNOON on 15th December, 2011 and registered as No 75 at page 75 Volume 176 of the Ministry of Lands Registry in the Office at Abakaliki  
Registrar of Deeds



CERTIFIED TRUE COPY  
CHIEF REGISTRAR OF DEEDS

*Roteflump 28/02/2012*



**EBONYI LANDS INFORMATION MANAGEMENT SYSTEM**



**SURVEY DESCRIPTION OF LANDED PROPERTY OF PAL1906**

**CHIDOZIE IGWE**

All that parcel of land at NTEZI - ABA in the EBONYI Local Government Area of the Ebonyi State of Nigeria, containing an Area of approximately 931.073 Square Metres shown on Ebonyi State of Nigeria Survey Plan No. DA/EB 266/10 (Tracing No. -) the boundaries of which are described below.

Starting at concrete pillar marked AN 7408 the coordinates of which are: 435.398 Metres North and 41.775 Metres West of a concrete pillar marked NK 48 the origin of ABAKALIKI cadastral surveys. The boundaries run in straight lines the bearings and length of which are as follows:

S/N	From	Bearing		Lengths in: M		To
		Degree (°)	Minute (')	Length		
	AN 7408	166	09'	30.81m		AN 7409
	AN 7409	250	12'	30.49m		AN 7410
	AN 7410	345	55'	30.44m		AN 7411
	AN 7411	69	32'	30.16m		AN 7408
		THE	STARTING	POINT		

All property beacons are concrete pillars, all bearing and length approximate and all bearings are referred to National /True North.

**For Surveyor-General**  
Ebonyi State of Nigeria

\*\*\*\*\*