

Ang/solo2  
Nº 0001353

LU/A1/538



EBONYI STATE OF NIGERIA

No. 77

Vol: 5

PAGE 77

Certificate of Occupancy

LDR No:.....

File No: PAL/2031

This is to certify that ZACCHEUS OSITA IKEJI of NO 12 IGWEORE STREET, ABAKALIKI. (hereinafter called the holder/holders) is/are granted a right of occupancy in respect of PROPERTY KNOWN AS PLOT J. 142 AGBAJA AZUMILI LAYOUT ABAKALIKI, EBONYI STATE. SITUATE. described in the Schedule and more particularly marked and delineated in the PLAN NO. NLS/EN139/95 attached to this certificate and thereon bordered or verged RED for the term of 89 (EIGHTY-NINE) year(s) from the 1ST JANUARY, 2012 subject to the provision of the LAND USE ACT, 1978 and to the provisions and conditions implied by virtue of the said Act and the Regulations for the time being in force made under the said Act and to the covenants and conditions herein contained.

- 1(a) RENT: N465.00 (FOUR HUNDRED AND SIXTY-FIVE NAIRA) per annum.
- (b) The rent hereby reserved shall be revised at the end of every 5 (FIVE) year(s) of the term of this grant.
- (c) Buildings to the value of not less than N1,000,000.00 (ONE MILLION NAIRA) to the satisfaction and in accordance with plans approved by the A.P.A or such officer as the A.P.A may appoint.

(d) Time within which such building(s) is/are to be erected and completed fit for occupation and use. Within 3 (THREE) year(s) from the date of commencement of the term of this certificate.

(e) Purpose for which the land granted may be used: RESIDENTIAL/COMMERCIAL

2. This certificate of occupancy is issued subject to the following Covenants and conditions being observed by the holder/holders:-

- (a) Not to erect or build or permit to be erected or built on the land hereby granted any buildings other than those covenanted to be erected by virtue of this certificate of occupancy and the regulations under the said Act not to make or permit to be made any addition or alteration to the said buildings to be erected except in accordance with plans and specification approved by the A.P.A of Ebonyi State of Nigeria or any other officer appointed by him.
- (b) To keep the exterior and interior of the buildings to be erected and the outbuilding and erections which may at any time during the term hereby created be erected on the land hereby granted and all additions to such buildings and outbuildings and the walls, fences and appurtenances thereof in good and tenable repair and condition.
- (c) Not to use the building on the said land whether now erected hereafter thereon for any purpose other than
- (d) Not to alienate the right of Certificate of Occupancy hereby granted or any part thereof by sale, assignment, mortgage, transfer of possession, sublease, or bequest or otherwise howsoever without the consent of the GOVERNOR first had and obtained.
- (e) Not to permit anything to be used or done upon any part of the granted premises which shall be noxious, noisy or offensive or be of any inconvenience or annoyance to tenants or occupiers of premises adjoining or near thereto.
- (f) To maintain standards of accommodation and sanitary and living conditions conformable with standards obtaining in the neighbourhood.
- (g) To pay forthwith with or without demand to the DEPUTY DIRECTOR LANDS or other persons appointed by him before the issue of this certificate, all survey fees, registration fees, and other charges due in respect of preparation and issue and registration of this certificate.
- (h) To pay an improvement premium of N 0.00 (N/A)
- (i) To install and operate water borne sewage system within six months from the date the buildings erected on the plot are connected to piped water-supply.
- (j) To pay with or without demand on the first day of January of each year the rent reserved in these presents or any other rent as may be revised in future.

22/08/12

RECERTIFIED under my hand this 27th day of Oct 2012

ARC. NWOGHA FRIDAY MOSES  
COMMISSIONER FOR LANDS, SURVEY AND HOUSING EBONYI STATE OF NIGERIA

(By virtue of Powers to grant Certificate of Occupancy and Right of Occupancy delegated to him by the Governor, under Section 4(a) and (b) of the Land Use Edict (now Law) No.2 of 1979 (as applicable in Ebonyi State), and Section 45 of the Land Use Act No.6 of 1978.

Signature of Holder / Holders ..... Signature of Witness .....

Name of Witness ..... Occupation of Witness .....

Address .....  
Ministry of Lands, Survey and Housing AI

10/12/012



Title Holder: ZACCHEUS OSITA IKEJI

Old File Number: LU/AI/538 New File Number: PAL/2031

Survey Plan No: NLS/EN139/95

Property Description: PROPERTY KNOWN AS PLOT J. 142 AGBAJA AZUMILI LAYOUT ABAKALIKI, EBONYI STATE. SITUATE.

EBONYI STATE  
one hundred  
STAMP DUTIES

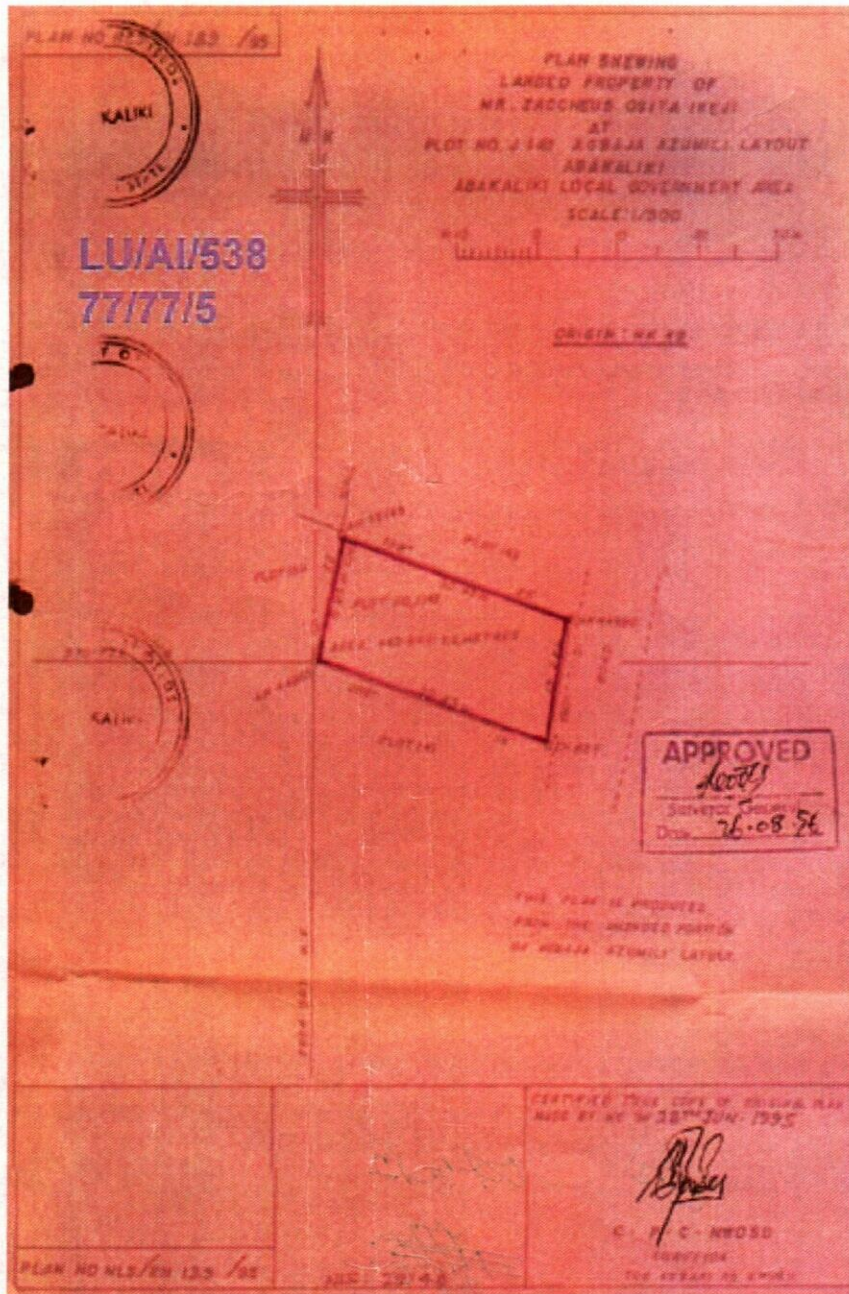

The within instrument in the opinion of the commissioner of stamp duties chargeable with the sum of N100.00 and the duty thereon has been assessed accordingly.

(Ssg) Obasi B.O  
SIGNED

Commissioner For Stamp Duties  
50 OF 31/7/2002

This instrument was delivered for registration at 1.30 O'Clock in the AFTERNOON on 18TH SEPTEMBER, 2002 and registered as No 77 at page 77 Volume 5 of the Ministry of Lands Registry in the Office at ABAKALIKI

Registrar of Deeds

GERTIFIED TRUE COPY  
REGISTRAR OF DEEDS



P A L / 2 0 3 1

Signature  
14/12/02

**EBONYI LANDS INFORMATION MANAGEMENT SYSTEM**

**SURVEY DESCRIPTION OF LANDED PROPERTY OF** *PAL/2031*
**MR ZACHEUS OSITA IKEJI AT NO J142 AGBAJA AZUMILI LAYOUT**

 All that parcel of land at **PLOT NO J142 AGBAJA AZUMILI** in the **ABAKALIKI**

 Local Government Area of the Ebonyi State of Nigeria, containing an Area of approximately **502463.640**

 Square Metres / Square Hectares shown on Ebonyi State of Nigeria Survey Plan No. **NLS/EN139/95** (Tracing No. **-**) the

boundaries of which are described below.

 Starting at concrete pillar marked **AN44883** the coordinates of which are:

**570.779** Metres North / South and **2824.303** Metres East / West of a concrete pillar

 marked **NK48** the origin of **ABAKALIKI** cadastral surveys. The

boundaries run in straight lines the bearings and length of which are as follows:

S/N	From	Bearing		Lengths in: M		To
		Degree (°)	Minute (')	Length		
	AN 44883	12	22	15.25		AN 33145
	AN33145	108	25	30.43		AN44880
	AN44880	190	15	15.24		EN 82T
	EN82T	288	18	30.83		AN44883

All property beacons are concrete pillars, all bearing and length approximate and all bearings are referred to National /True North.

 For Surveyor-General  
Ebonyi State of Nigeria

\*\*\*\*\*