

Nº 0000973



EBONYI STATE OF NIGERIA

ESS/LULAM/1960

Mar/41/012  
NO. 42

Vol: 195

PAGE 42

Certificate of Occupancy

File No: PAL/2272

LDR No:.....

This is to certify that **UGWUOKE IKECHUKWU SYLVESTER** of **FEDERAL MEDICAL CENTRE ABKALIKI** (hereinafter called the holder/holders) is/are granted a right of occupancy in respect of **LAND SITUATE AND LYING AT EDDA ECHARA IN EBONYI LOCAL GOVERNMENT AREA OF EBONYI STATE** described in the Schedule and more particularly marked and delineated in the **PLAN NO. OTE/EB 140/2006** attached to this certificate and thereon bordered or verged **RED** for the term of **99 (NINETY-NINE)** year(s) from the **1ST JANUARY, 2012** subject to the provision of the **LAND USE ACT, 1978** and to the provisions and conditions implied by virtue of the said Act and the Regulations for the time being in force made under the said Act and to the covenants and conditions herein contained.

- 1(a) RENT: **NI,390.00 (ONE THOUSAND THREE HUNDRED AND NINETY NAIRA)** per annum.
- (b) The rent hereby reserved shall be revised at the end of every **5 (FIVE)** year(s) of the term of this grant.
- (c) Buildings to the value of not less than **NI,000,000.00 (ONE MILLION NAIRA)** to the satisfaction and in accordance with plans approved by the **A.P.A** or such officer as the **A.P.A** may appoint.
- (d) Time within which such building(s) is/are to be erected and completed fit for occupation and use. Within **3 (THREE)** year(s) from the date of commencement of the term of this certificate.
- (e) Purpose for which the land granted may be used: **RESIDENTIAL**

2. This certificate of occupancy is issued subject to the following Covenants and conditions being observed by the holder/holders:-

- (a) Not to erect or build or permit to be erected or built on the land hereby granted any buildings other than those covenanted to be erected by virtue of this certificate of occupancy and the regulations under the said Act not to make or permit to be made any addition or alteration to the said buildings to be erected except in accordance with plans and specification approved by the **A.P.A** of Ebonyi State of Nigeria or any other officer appointed by him.
- (b) To keep the exterior and interior of the buildings to be erected and the outbuilding and erections which may at any time during the term hereby created be erected on the land hereby granted and all additions to such buildings and outbuildings and the walls, fences and appurtenances thereof in good and tenatable repair and condition.
- (c) Not to use the building on the said land whether now erected hereafter thereon for any purpose other than
- (d) Not to alienate the right of Certificate of Occupancy hereby granted or any part thereof by sale, assignment, mortgage, transfer of possession, sublease, or bequest or otherwise howsoever without the consent of the **GOVERNOR** first had and obtained.
- (e) Not to permit anything to be used or done upon any part of the granted premises which shall be noxious, noisy or offensive or be of any inconvenience or annoyance to tenants or occupiers of premises adjoining or near thereto.
- (f) To maintain standards of accommodation and sanitary and living conditions conformable with standards obtaining in the neighbourhood.
- (g) To pay forthwith with or without demand to the **DEPUTY DIRECTOR LAND** or other persons appointed by him before the issue of this certificate, all survey fees, registration fees, and other charges due in respect of preparation and issue and registration of this certificate.
- (h) Paid an improvement premium of **N00.00 (N/A)**
- (i) To install and operate water borne sewage system within six months from the date the buildings erected on the plot are connected to piped water-supply.
- (j) To pay with or without demand on the first day of January of each year the rent reserved in these presents or any other rent as may be revised in future.

GIVEN under my hand this 27<sup>th</sup> day of March 2012

**ARC. NWOGHA FRIDAY MOSES**  
**COMMISSIONER FOR LANDS, SURVEY AND HOUSING EBONYI STATE OF NIGERIA**

(By virtue of Powers to grant Certificate of Occupancy and Right of Occupancy delegated to him by the Governor, under Section 4(a) and (b) of the Land Use Edict (now Law) N0.2 of 1979 (as applicable in Ebonyi State), and Section 45 of the Land Use Act No.6 of 1978.

Signature of Holder / Holders ..... Signature of Witness .....

Name of Witness Nwome B. U Occupation of Witness Civil Servant

Address Min. of Lands, Survey and Housing Abakaliki

30/4/012



15/5/012

Title Holder: UGWUOKE IKECHUKWU SYLVESTER

Old File Number: EBS/LU/AI//1960 New File Number: PAL/2272

Survey Plan No: OTE/EB 140/2006



Property Description: LAND SITUATE AND LYING AT EDDA ECHARA IN EBONYI LOCAL GOVERNMENT AREA OF EBONYI STATE

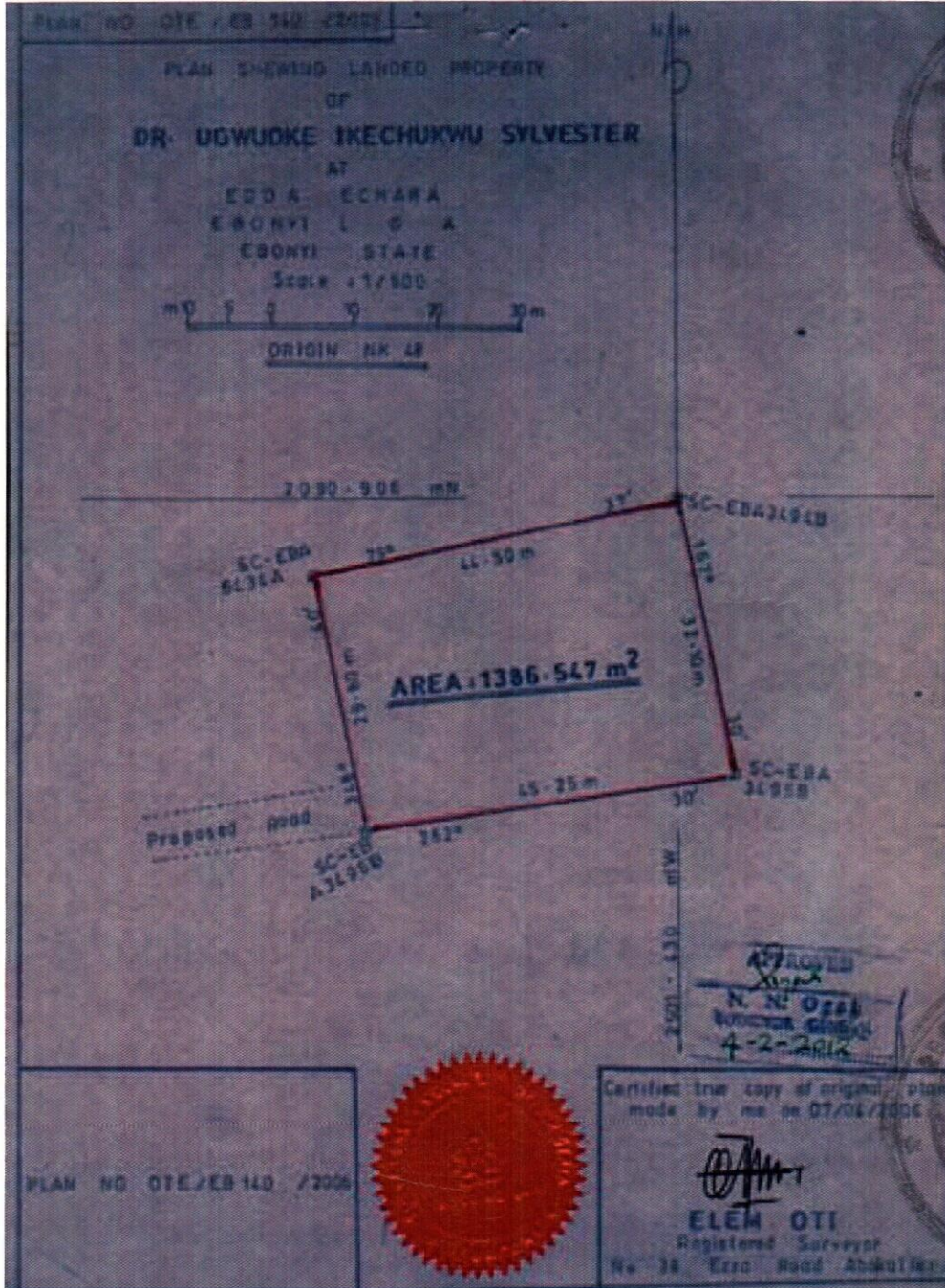

<p>The within instrument in the opinion of the commissioner of stamp duties chargeable with the sum of N100.00 and the duty thereon has been assessed accordingly.</p> <p>(Sgd) <i>Obasi B O</i></p> <p><b>Commissioner For Stamp Duties</b> RCR NO 0115227 OF 14/02/2012</p>	<p>This instrument was delivered for registration at 10:27 O'clock in the FORENOON on 12th March, 2012 and registered as No 42 at page 42 Volume 195 of the Ministry of Lands Registry in the Office at Abakaliki</p> <p><i>[Signature]</i></p> <p><b>Registrar of Deeds</b></p>
---	--



*By Moku 315/12*



**EBONYI LANDS INFORMATION MANAGEMENT SYSTEM**



**SURVEY DESCRIPTION OF LANDED PROPERTY OF PAL/2272**

**UGWUOKE SYLVESTER**

All that parcel of land at **EDDA ACHARA IZZI** in the **EBONYI**

Local Government Area of the Ebonyi State of Nigeria, containing an Area of approximately

**1386.547** Square Metres shown on Ebonyi State of Nigeria Survey Plan No.

**OTE/EB 140 /2006** (Tracing No. ) the

boundaries of which are described below.

Starting at concrete pillar marked **SCEBA 3494B** the coordinates of which are:

**2090.906** Metres North and **2501.430** Metres East of a concrete pillar marked

**NK 48** the origin of **ABAKALIKI** cadastral surveys. The boundaries run

in straight lines the bearings and length of which are as follows:

S/N	From	Bearing		Lengths in: M		To
		Degree (°)	Minute (')	Length		
	SC-EBA 3494B	167	30	32.10		SC-EBA 3495B
	SC-EBA 3495B	262	30	45.25		SC-EBA 3496B
	SC-EBA 3496B	348	40	29.80		SC-EBA 6434A
	SC-EBA 6434A	79	37	44.50		SC-EBA 3494B
						The starting point

All property beacons are concrete pillars, all bearing and length approximate and all bearings are referred to National /True North.

*[Signature]*  
For Surveyor General  
Ebonyi State of Nigeria

\*\*\*\*\*