

JAN/23/01  
Nº 0000224



EBONYI STATE OF NIGERIA

No. 23

VOL: 133

PAGE 23

Certificate of Occupancy

LDR No:.....

File No: PAL/242

This is to certify that **NZEWUIHE IKECHUKWU RICHARD** of **NO 11 AWKA STREET ABAKALIKI**. (hereinafter called the holder/holders) is/are granted a right of occupancy in respect of **NO 11 AKWA STREET (ABAKPA)LAYOUT ABAKALIKI LOCAL GOVERNMENT AREA EBONYI STATE**. described in the Schedule and more particularly marked and delineated in the **PLAN NO. OTE/EB 1032/2009** attached to this certificate and thereon bordered or verged **RED** for the term of **99 (NINETY-NINE)** year(s) from the **1ST JANUARY, 2010** subject to the provision of the **LAND USE ACT, 1978** and to the provisions and conditions implied by virtue of the said Act and the Regulations for the time being in force made under the said Act and to the covenants and conditions herein contained.

- 1(a) RENT: **N595.00 (FIVE HUNDRED AND NINETY-FIVE NAIRA)** per annum.
- (b) The rent hereby reserved shall be revised at the end of every **5 (FIVE)** year(s) of the term of this grant.
- (c) Buildings to the value of not less than **N1,000,000.00 (ONE MILLION NAIRA)** to the satisfaction and in accordance with plans approved by the **A.P.A** or such officer as the **A.P.A** may appoint.
- (d) Time within which such building(s) is/are to be erected and completed fit for occupation and use. Within **3 (THREE)** year(s) from the date of commencement of the term of this certificate.
- (e) Purpose for which the land granted may be used: **RESIDENTIAL**

2. This certificate of occupancy is issued subject to the following Covenants and conditions being observed by the holder/holders:-

- (a) Not to erect or build or permit to be erected or built on the land hereby granted any buildings other than those covenanted to be erected by virtue of this certificate of occupancy and the regulations under the said Act not to make or permit to be made any addition or alteration to the said buildings to be erected except in accordance with plans and specification approved by the **A.P.A** of Ebonyi State of Nigeria or any other officer appointed by him.
- (b) To keep the exterior and interior of the buildings to be erected and the outbuilding and erections which may at any time during the term hereby created be erected on the land hereby granted and all additions to such buildings and outbuildings and the walls, fences and appurtenances thereof in good and tenantable repair and condition.
- (c) Not to use the building on the said land whether now erected hereafter thereon for any purpose other than
- (d) Not to alienate the right of Certificate of Occupancy hereby granted or any part thereof by sale, assignment, mortgage, transfer of possession, sublease, or bequest or otherwise howsoever without the consent of the **GOVERNOR** first had and obtained.
- (e) Not to permit anything to be used or done upon any part of the granted premises which shall be noxious, noisy or offensive or be of any inconvenience or annoyance to tenants or occupiers of premises adjoining or near thereto.
- (f) To maintain standards of accommodation and sanitary and living conditions conformable with standards obtaining in the neighbourhood.
- (g) To pay forthwith with or without demand to the **DEPUTY DIRECTOR LAND** or other persons appointed by him before the issue of this certificate, all survey fees, registration fees, and other charges due in respect of preparation and issue and registration of this certificate.
- (h) Paid an improvement premium of **N0.00 (N/A)**
- (i) To install and operate water borne sewage system within six months from the date the buildings erected on the plot are connected to piped water-supply.
- (j) To pay with or without demand on the first day of January of each year the rent reserved in these presents or any other rent as may be revised in future.

GIVEN under my hand this 18th day of March 2011

**COMRADE JONAH EGBA**

**COMMISSIONER FOR LANDS, SURVEY AND HOUSING EBONYI STATE OF NIGERIA**

(By virtue of Powers to grant Certificate of Occupancy and Right of Occupancy delegated to him by the Governor, under Section 4(a) and (b) of the Land Use Edict (now Law) NO.2 of 1979 (as applicable in Ebonyi State), and Section 45 of the Land Use Act No.6 of 1978.

Signature of Holder / Holders ..... Signature of Witness .....

Name of Witness Olufemi Samuel Occupation of Witness Chief Serranil

Address Ministry of Lands Survey & Housing AP



24/4/01

**Title Holder:** NZEWUIHE IKECHUKWU RICHARD

**Old File Number:** EBS/LU/AI/1333 **New File Number:** PAL/242

**Survey Plan No:** OTE/EB 1032/2009

**Property Description:** NO 11 AKWA STREET (ABAKPA)LAYOUT ABAKALIKI LOCAL GOVERNMENT AREA EBONYI STATE.

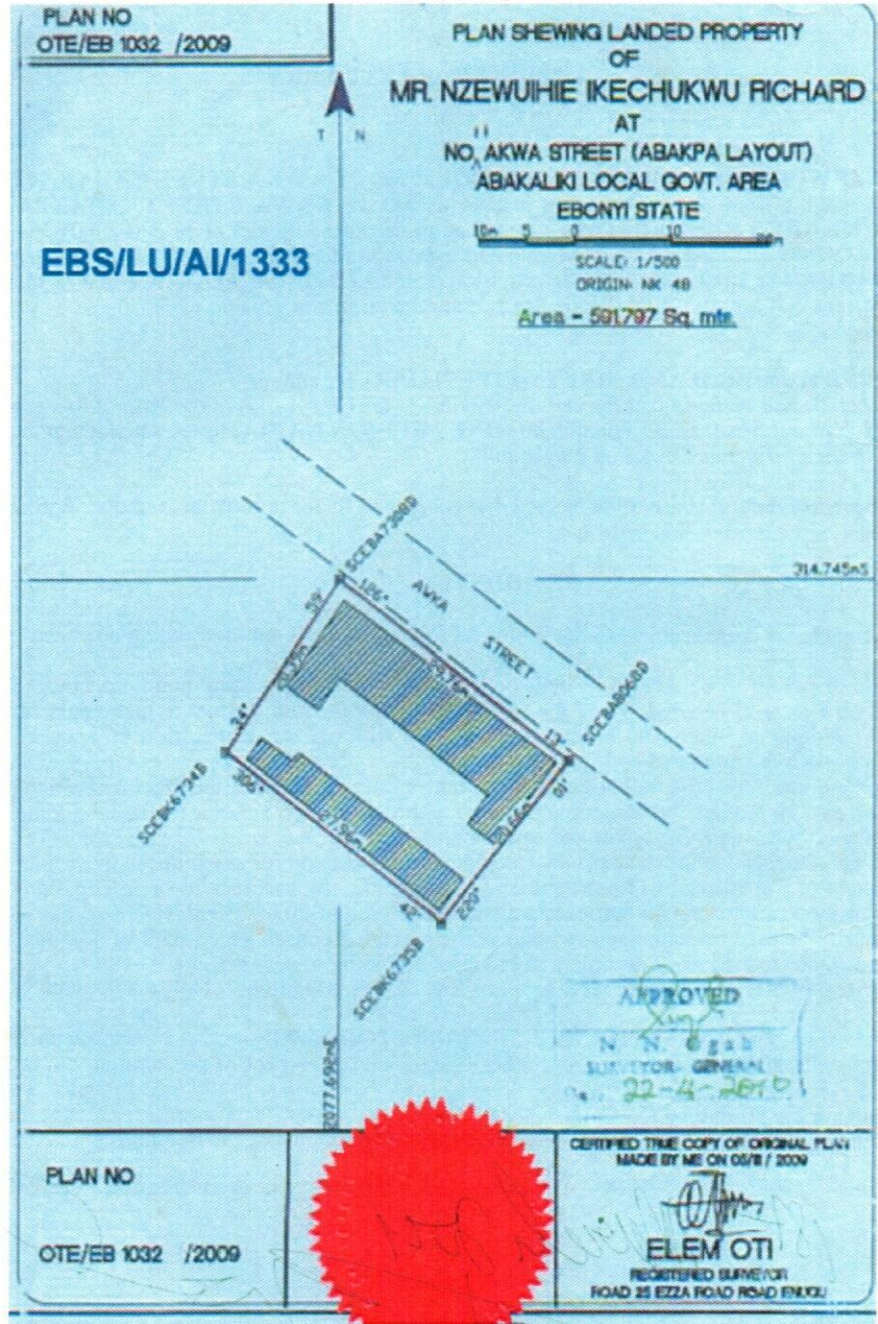

The within instrument in the opinion of the commissioner of stamp duties chargeable with the sum of N100.00 and the duty thereon has been assessed accordingly.

(sgd) *Obasi B. O.*  
Commissioner For Stamp Duties  
(0051467)OF1/11/010

This instrument was delivered for registration at 13:50 O'Clock in the AFTERNOON on 20th January, 2011 and registered as No 23 at page 23 Volume 133 of the Ministry of Lands Registry in the Office at Abakaliki.

*[Signature]*  
Registrar of Deeds

**MINISTRY OF LANDS AND SURVEY**  
**EBONYI STATE**

**CERTIFIED TRUE COPY**  
*[Signature]*  
REGISTRAR OF DEEDS



*Palma s/stall*

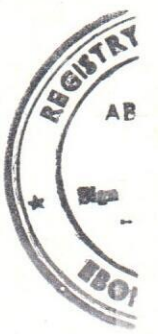
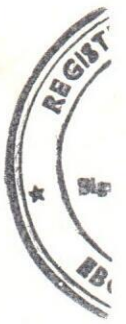



EBONYI LANDS INFORMATION MANAGEMENT SYSTEM



DESCRIPTION OF LANDED PROPERTY OF PAL/146

NZEWUIHE IKECHUKWU RICHARD

NO 11 AKWA STREET ABAKPA

All the parcel of land at in the ABAKALIKI

Local Government Area of the Ebonyi State of Nigeria, containing an Area of approximately

591.797 Square Metres shown on Ebonyi State of Nigeria Survey Plan No.

OTE/EB1032/2009 (Tracing No. ) the

boundaries of which are described below.

Starting at concrete pillar marked SC-EBA 7308D the coordinates of which are:

314.745 Metres SOUTH and 2077.692 Metres West of a concrete pillar marked

NK 48T the origin of ABAKALIKI cadastral surveys. The boundaries run

in straight lines the bearings and length of which are as follows:

S/N	From	Bearing		Lengths in: M		To
		Degree (°)	Minute (')	Length		
	SC-EBA7308D	126	13	29.76		SC-EBA8068D
	SC-EBA8068D	220	01	20.66		SC-EBK6735B
	SC-EBK6735B	306	42	27.96		SC-EBK6734B
	SC-EBK6734B	34	59	20.39		SC-EBA7308D

All property beacons are concrete pillars, all bearing and length approximate and all bearings are referred to National /True North.

For Surveyor-General  
Ebonyi State of Nigeria

\*\*\*\*\*