

Jun/70/012  
Nº 0001322



EBS/Lu/AI/1363

EBONYI STATE OF NIGERIA

No. 45

Vol: 140

PAGE 45

Certificate of Occupancy

LDR No:.....

File No: PAL/2721

This is to certify that **OKEKE EDWIN AMACHUKWU** of **NO 32 NEW MARKET ROAD, ABAKALIKI** (hereinafter called the holder/holders) is/are granted a right of occupancy in respect of **PROPERTY KNOWN AS PLOT NO. 92 IN BLOCK 1 AZUYIUDENE LAYOUT ABAKALIKI IN ABAKALIKI L.G.A, EBONYI STATE.** described in the Schedule and more particularly marked and delineated in the **PLAN NO. DA/EB 84/2010** attached to this certificate and thereon bordered or verged **RED** for the term of **99 (NINETY-NINE)** year(s) from the **1ST JANUARY, 2012** subject to the provision of the **LAND USE ACT, 1978** and to the provisions and conditions implied by virtue of the said Act and the Regulations for the time being in force made under the said Act and to the covenants and conditions herein contained.

- 1(a) RENT: **N400.00 (FOUR HUNDRED NAIRA)** per annum.
- (b) The rent hereby reserved shall be revised at the end of every **5 (FIVE)** year(s) of the term of this grant.
- (c) Buildings to the value of not less than **N1,000,000.00 (ONE MILLION NAIRA)** to the satisfaction and in accordance with plans approved by the **A.P.A** or such officer as the **A.P.A** may appoint.
- (d) Time within which such building(s) is/are to be erected and completed fit for occupation and use. Within **3 (THREE)** year(s) from the date of commencement of the term of this certificate.
- (e) Purpose for which the land granted may be used: **RESIDENTIAL/COMMERCIAL**

2. This certificate of occupancy is issued subject to the following Covenants and conditions being observed by the holder/holders:

- (a) Not to erect or build or permit to be erected or built on the land hereby granted any buildings other than those covenanted to be erected by virtue of this certificate of occupancy and the regulations under the said Act not to make or permit to be made any addition or alteration to the said buildings to be erected except in accordance with plans and specification approved by the **A.P.A** of Ebonyi State of Nigeria or any other officer appointed by him.
- (b) To keep the exterior and interior of the buildings to be erected and the outbuilding and erections which may at any time during the term hereby created be erected on the land hereby granted and all additions to such buildings and outbuildings and the walls, fences and appurtenances thereof in good and tenantable repair and condition.
- (c) Not to use the building on the said land whether now erected hereafter thereon for any purpose other than
- (d) Not to alienate the right of Certificate of Occupancy hereby granted or any part thereof by sale, assignment, mortgage, transfer of possession, sublease, or bequest or otherwise howsoever without the consent of the **GOVERNOR** first had and obtained.
- (e) Not to permit anything to be used or done upon any part of the granted premises which shall be noxious, noisy or offensive or be of any inconvenience or annoyance to tenants or occupiers of premises adjoining or near thereto.
- (f) To maintain standards of accommodation and sanitary and living conditions conformable with standards obtaining in the neighbourhood.
- (g) To pay forthwith with or without demand to the **DEPUTY DIRECTOR LAND** or other persons appointed by him before the issue of this certificate, all survey fees, registration fees, and other charges due in respect of preparation and issue and registration of this certificate.
- (h) Paid an improvement premium of **N00.00 (N/A)**
- (i) To install and operate water borne sewage system within six months from the date the buildings erected on the plot are connected to piped water-supply.
- (j) To pay with or without demand on the first day of January of each year the rent reserved in these presents or any other rent as may be revised in future.

2/8/013

GIVEN under my hand this 21st day of January 2013

**ARC. NWOGHA FRIDAY MOSES**  
COMMISSIONER FOR LANDS, SURVEY AND HOUSING EBONYI STATE OF NIGERIA

(By virtue of Powers to grant Certificate of Occupancy and Right of Occupancy delegated to him by the Governor, under Section 4(a) and (b) of the Land Use Edict (now Law) No.2 of 1979 (as applicable in Ebonyi State), and Section 45 of the Land Use Act No.6 of 1978.

Signature of Holder / Holders ..... Manchukwu ..... Signature of Witness ..... [Signature] .....

Name of Witness Nwae B. U ..... Occupation of Witness Civil Service .....

Address Min. of Lands, Survey and Housing Abakaliki .....

8/02/013





Title Holder: OKEKE EDWIN AMACHUKWU

Old File Number: EBS/LU/AI/1363 New File Number: PAL/2721

Survey Plan No: DA/EB 84/2010

Property Description: PROPERTY KNOWN AS PLOT NO. 92 IN BLOCK 1 AZUIYIUDENE LAYOUT ABAKALIKI IN ABAKALIKI L.G.A, EBONYI STATE.

Stamp Duties  
Okeke Edwin Amachukwu

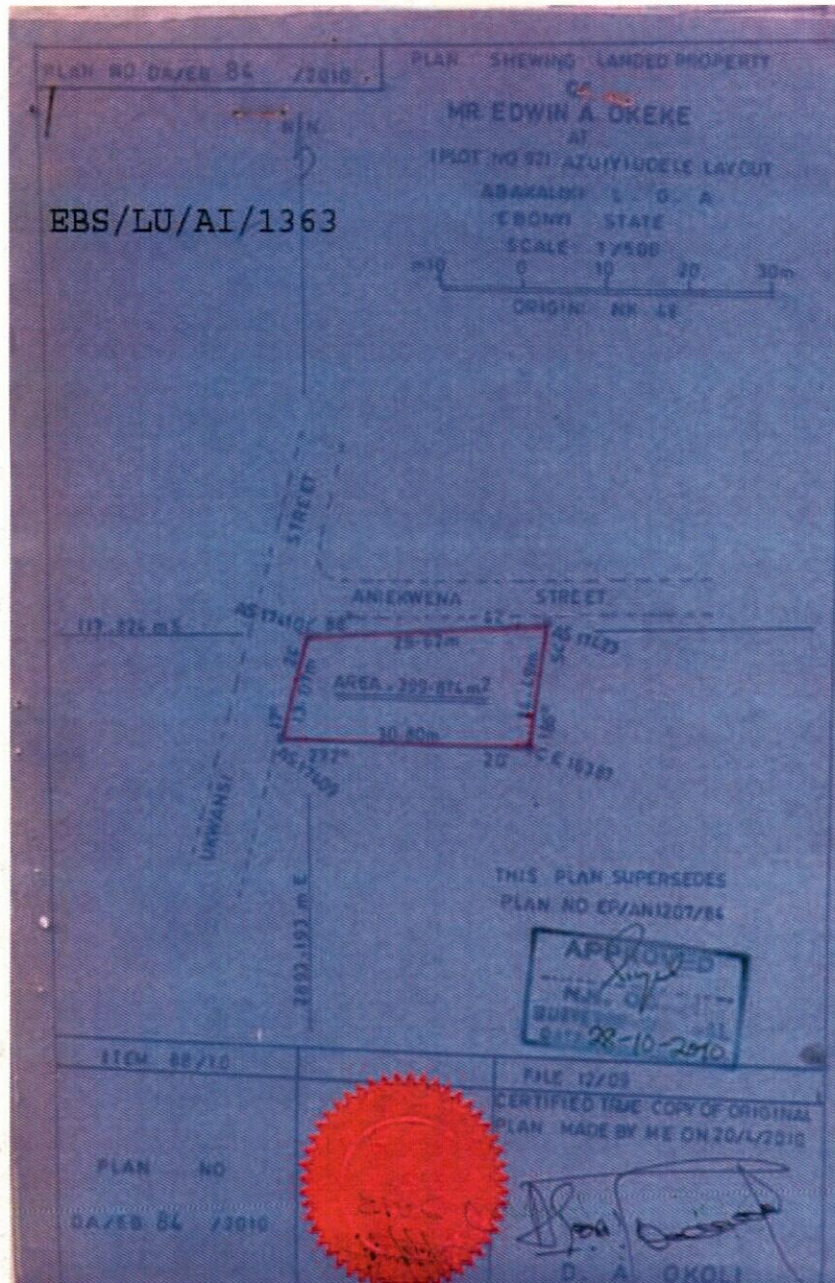

The within instrument in the opinion of the commissioner of stamp duties chargeable with the sum of N100.00 and the duty thereon has been assessed accordingly.

(sgd) Okeke E. O.

Commissioner For Stamp Duties  
RCR NO 093788 OF 11/7/2011

This instrument was delivered for registration at 15:7 O'Clock in the AFTERNOON on 14th June, 2012 and registered as No. 45 Volume 140 of the Ministry of Lands Registry in the Office at Abakaliki

Registrar of Deeds

CERTIFIED TRUE COPY

REGISTRAR OF DEEDS



PAL/2721

12/02/13





**EBONYI LANDS INFORMATION MANAGEMENT SYSTEM**



**SURVEY DESCRIPTION OF LANDED PROPERTY OF** PAL/2721

**OKEKE EDWIN AMACHUKWU**

All that parcel of land at **PLOT NO.92 AZUIYIUDENE LAYOUT** in the **ABAKALIKI** Local Government Area of the Ebonyi State of Nigeria, containing an Area of approximately **399.874** Square Metres shown on Ebonyi State of Nigeria Survey Plan No. **DA/EB 84/2010** (Tracing No. ) the boundaries of which are described below.

Starting at concrete pillar marked **AS 17410** the coordinates of which are: **117.824** Metre South and **2893.193** Metres East of a concrete pillar marked **NK 48** the origin of **ABAKALIKI** cadastral surveys. The boundaries run in straight lines the bearings and length of which are as follows:

S/N	From	Bearing		Lengths in: M		To
		Degree (°)	Minute (')	Length		
	AS 17410	88	42	28.62		AS 17423
	AS 17423	186	54	14.49		CE 16387
	CE 16387	272	20	30.80		AS 17409
	AS 17409	17	24	13.07		AS 17410
			THE	STARTING		POINT

All property beacons are concrete pillars, all bearing and length approximate and all bearings are referred to National /True North.

**For Surveyor-General**  
Ebonyi State of Nigeria

\*\*\*\*\*