

Nº 0001396



EB/ku/1/2006

may/137/012

EBONYI STATE OF NIGERIA

No. 2

A/SUR/NO/206/6/2012/EB59

Vol: 219

PAGE 2

Certificate of Occupancy

LDR No:.....

File No: PAL/2852

This is to certify that ONWUDIWE EMEKA CHRIS of NO 2 ANETO ONWUDIWE STREET, UPPER NORTH, TRANS-EKULU PHASE V, ENUGU, ENUGU STATE (hereinafter called the holder/holders) is/are granted a right of occupancy in respect of PLOT 353 IN BLOCK 'I' AZUIYIUDENE LAYOUT, ABAKALIKI, EBONYI LOCAL AREA described in the Schedule and more particularly marked and delineated in the PLAN NO. SC/EB 007/2011 attached to this certificate and thereon bordered or verged RED for the term of 99 (NINETY-NINE) year(s) from the 1ST JANUARY, 2012 subject to the provision of the LAND USE ACT, 1978 and to the provisions and conditions implied by virtue of the said Act and the Regulations for the time being in force made under the said Act and to the covenants and conditions herein contained.

1(a) RENT: N603.00 (SIX HUNDRED AND THREE NAIRA) per annum.

(b) The rent hereby reserved shall be revised at the end of every 5 (FIVE) year(s) of the term of this grant.

(c) Buildings to the value of not less than N1,000,000.00 (ONE MILLION NAIRA) to the satisfaction and in accordance with plans approved by the A.P.A or such officer as the A.P.A may appoint.

(d) Time within which such building(s) is/are to be erected and completed fit for occupation and use. Within 3 (THREE) year(s) from the date of commencement of the term of this certificate.

(e) Purpose for which the land granted may be used: RESIDENTIAL

2. This certificate of occupancy is issued subject to the following Covenants and conditions being observed by the holder/holders:-

(a) Not to erect or build or permit to be erected or built on the land hereby granted any buildings other than those covenanted to be erected by virtue of this certificate of occupancy and the regulations under the said Act not to make or permit to be made any addition or alteration to the said buildings to be erected except in accordance with plans and specification approved by the A.P.A of Ebonyi State of Nigeria or any other officer appointed by him.

(b) To keep the exterior and interior of the buildings to be erected and the outbuilding and erections which may at any time during the term hereby created be erected on the land hereby granted and all additions to such buildings and outbuildings and the walls, fences and appurtenances thereof in good and tenantable repair and condition.

(c) Not to use the building on the said land whether now erected hereafter thereon for any purpose other than

(d) Not to alienate the right of Certificate of Occupancy hereby granted or any part thereof by sale, assignment, mortgage, transfer of possession, sublease, or bequest or otherwise howsoever without the consent of the GOVERNOR first had and obtained.

(e) Not to permit anything to be used or done upon any part of the granted premises which shall be noxious, noisy or offensive or be of any inconvenience or annoyance to tenants or occupiers of premises adjoining or near thereto.

(f) To maintain standards of accommodation and sanitary and living conditions conformable with standards obtaining in the neighbourhood.

(g) To pay forthwith with or without demand to the DEPUTY DIRECTOR LAND or other persons appointed by him before the issue of this certificate, all survey fees, registration fees, and other charges due in respect of preparation and issue and registration of this certificate.

(h) Paid an improvement premium of N00.00 (NOT APPLICABLE)

(i) To install and operate water borne sewage system within six months from the date the buildings erected on the plot are connected to piped water-supply.

(j) To pay with or without demand on the first day of January of each year the rent reserved in these presents or any other rent as may be revised in future.

GIVEN under my hand this 25th day of June 2012

ARC. NWOGHA FRIDAY MOSES

COMMISSIONER FOR LANDS, SURVEY AND HOUSING EBONYI STATE OF NIGERIA

(By virtue of Powers to grant Certificate of Occupancy and Right of Occupancy delegated to him by the Governor, under Section 4(a) and (b) of the Land Use Edict (now Law) No. 2 of 1979 (as applicable in Ebonyi State), and Section 45 of the Land Use Act No. 6 of 1978.

Signature of Holder / Holders Signature of Witness

Name of Witness UGHUMBA RITA Occupation of Witness CIVIL SERVANT

Address MINISTRY OF LANDS SURVEY AND HOUSING ABAKALIKI

08/06/012



Title Holder: ONWUDIWE EMEKA CHRIS

Old File Number: EBS/LU/AI/2066 New File Number: PAL/2852

Survey Plan No: SC/EB 007/2011

Property Description: PLOT 353 IN BLOCK 'T' AZUIYUDENE LAYOUT, ABAKALIKI, EBONYI LOCAL AREA

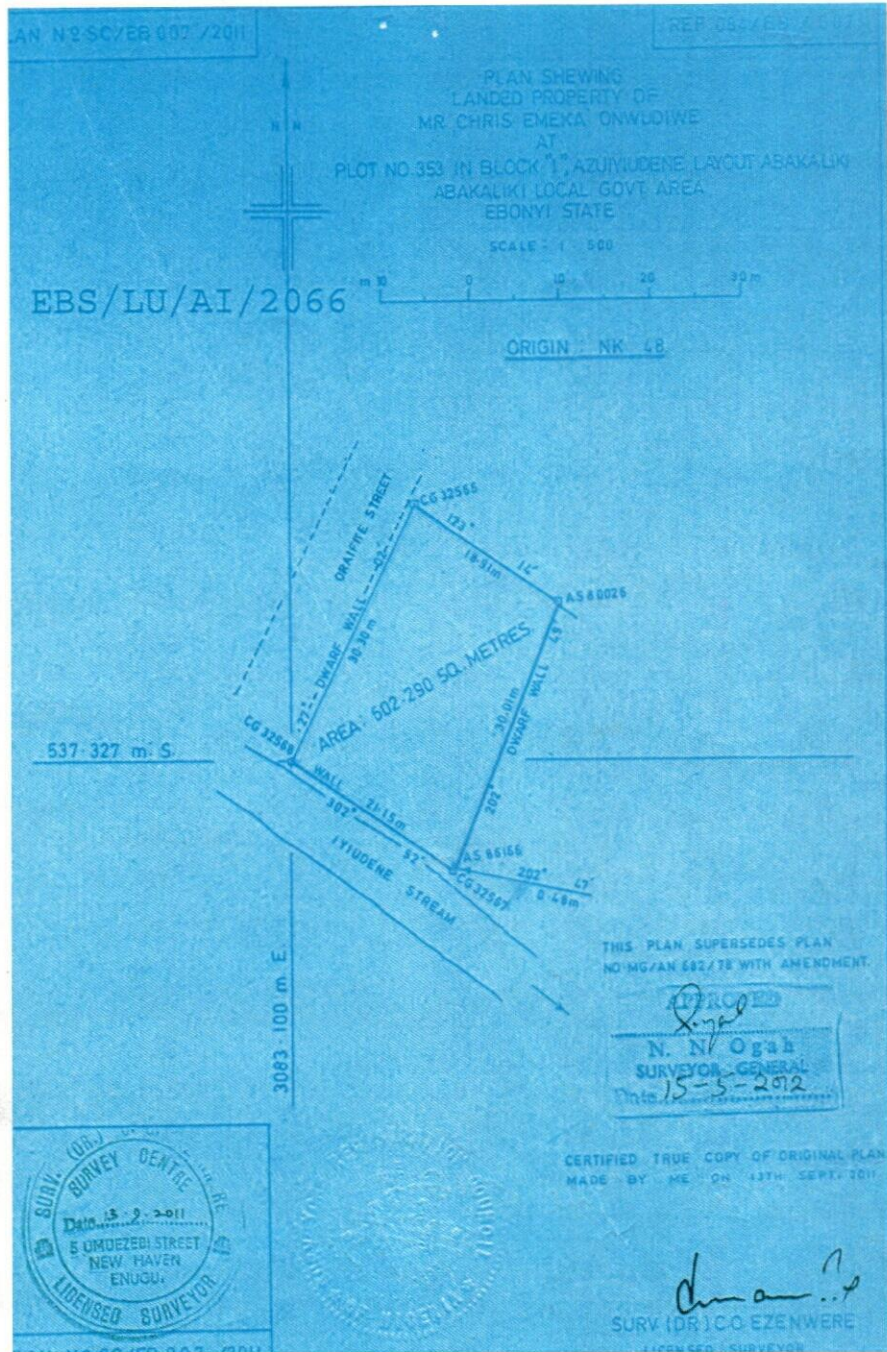
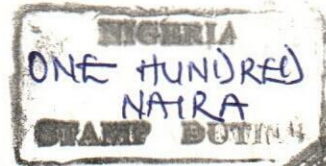

The within instrument in the opinion of the commissioner of stamp duties chargeable with the sum of N100.00 and the duty thereon has been assessed accordingly.

(Sd/s) OBASI B.O
Commissioner For Stamp Duties
RCR NO 0145899 OF 17/05/012

This instrument was delivered for registration at 14:17 O'clock in the AFTERNOON on 22nd May, 2012 and registered as No 2 at page 2 Volume 219 of the Ministry of Lands Registry in the Office at Abakaliki

[Signature]
Registrar of Deeds

CERTIFIED TRUE COPY

REGISTRAR OF DEEDS



P A L / 2 8 5 2

[Handwritten signature]
11/07/12



EBONYI LANDS INFORMATION MANAGEMENT SYSTEM

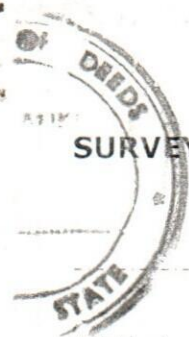

SURVEY DESCRIPTION OF LANDED PROPERTY OF PAL/2852

ONWUDIWE EMEKA CHRIS

All that parcel of land at **PLOT NO 353 AZUIYIUDENE LAYOUT** in the **ABAKALIKI**

Local Government Area of the Ebonyi State of Nigeria, containing an Area of approximately **602.290** Square Metres shown on Ebonyi State of Nigeria Survey Plan No. **SC/EB 007/2011** (Tracing No.) the boundaries of which are described below.

Starting at concrete pillar marked **CG 32568** the coordinates of which are: **537.327** Metres South and **3083.100** Metres East of a concrete pillar marked **NK 48** the origin of Abakaliki cadastral surveys. The boundaries run in straight lines the bearings and length of which are as follows:

S/N	From	Bearing		Lengths in: M		To
		Degree (°)	Minute (')	Length		
	CG 32568	27	02	30.30		CG 32565
	CG 32565	123	14	18.91		AS 80026
	AS 80026	202	49	30.01		AS 86166
	AS 86166	202	47	0.48		CG 32567
	CG 32567	302	52	21.15		CG 32568

All property beacons are concrete pillars, all bearing and length approximate and all bearings are referred to National /True North.

[Signature]
For Surveyor General
 Ebonyi State of Nigeria
