

Aug/21/012

Nº 0001639



ERBS/LUBA/2098

EBONYI STATE OF NIGERIA

No. 100

Vol: 219

PAGE 100

Certificate of Occupancy

LDR No:.....

File No: PAL/3314

This is to certify that UCHECHUKWU ONYEMENAM of NO.10 AGUIYI IRONSI STREET, ABAKALIKI. (hereinafter called the holder/holders) is/are granted a right of occupancy in respect of LAND AT CHUKWU UKPABI AMUZU IGBEAGU IN IZZI LOCAL GOVERNMENT AREA OF EBONYI STATE, described in the Schedule and more particularly marked and delineated in the PLAN NO. HT/EB 134B/2009 attached to this certificate and thereon bordered or verged RED for the term of 99 (NINETY-NINE) year(s) from the 1ST JANUARY, 2012 subject to the provision of the LAND USE ACT, 1978 and to the provisions and conditions implied by virtue of the said Act and the Regulations for the time being in force made under the said Act and to the covenants and conditions herein contained.

- 1(a) RENT: N10,900.00 (TEN THOUSAND NINE HUNDRED NAIRA) per annum.
- (b) The rent hereby reserved shall be revised at the end of every 5 (FIVE) year(s) of the term of this grant.
- (c) Buildings to the value of not less than N1,000,000.00 (ONE MILLION NAIRA) to the satisfaction and in accordance with plans approved by the A.P.A or such officer as the A.P.A may appoint.
- (d) Time within which such building(s) is/are to be erected and completed fit for occupation and use. Within 3 (THREE) year(s) from the date of commencement of the term of this certificate.
- (e) Purpose for which the land granted may be used: RESIDENTIAL

2. This certificate of occupancy is issued subject to the following Covenants and conditions being observed by the holder/holders:-

- (a) Not to erect or build or permit to be erected or built on the land hereby granted any buildings other than those covenanted to be erected by virtue of this certificate of occupancy and the regulations under the said Act not to make or permit to be made any addition or alteration to the said buildings to be erected except in accordance with plans and specification approved by the A.P.A of Ebonyi State of Nigeria or any other officer appointed by him.
- (b) To keep the exterior and interior of the buildings to be erected and the outbuilding and erections which may at any time during the term hereby created be erected on the land hereby granted and all additions to such buildings and outbuildings and the walls, fences and appurtenances thereof in good and tenantable repair and condition.
- (c) Not to use the building on the said land whether now erected hereafter thereon for any purpose other than
- (d) Not to alienate the right of Certificate of Occupancy hereby granted or any part thereof by sale, assignment, mortgage, transfer of possession, sublease, or bequest or otherwise howsoever without the consent of the GOVERNOR first had and obtained.
- (e) Not to permit anything to be used or done upon any part of the granted premises which shall be noxious, noisy or offensive or be of any inconvenience or annoyance to tenants or occupiers of premises adjoining or near thereto.
- (f) To maintain standards of accommodation and sanitary and living conditions conformable with standards obtaining in the neighbourhood.
- (g) To pay forthwith with or without demand to the DEPUTY DIRECTOR LAND or other persons appointed by him before the issue of this certificate, all survey fees, registration fees, and other charges due in respect of preparation and issue and registration of this certificate.
- (h) Paid an improvement premium of N0.00 (N/A)
- (i) To install and operate water borne sewage system within six months from the date the buildings erected on the plot are connected to piped water-supply.
- (j) To pay with or without demand on the first day of January of each year the rent reserved in these presents or any other rent as may be revised in future.

18/12/012

GIVEN under my hand this 16th day of Oct 2012

ARC. NWOGHA FRIDAY MOSES COMMISSIONER FOR LANDS, SURVEY AND HOUSING EBONYI STATE OF NIGERIA

(By virtue of Powers to grant Certificate of Occupancy and Right of Occupancy delegated to him by the Governor, under Section 4(a) and (b) of the Land Use Edict (now Law) NO.2 of 1979 (as applicable in Ebonyi State), and Section 45 of the Land Use Act No.6 of 1978.

Signature of Holder / Holders ..... Signature of Witness .....

Name of Witness ONELE, T. C Occupation of Witness CIVIL SERVICE

Address MIN. OF LANDS, SURVEY & HOUSING, ABAKALIKI

14/12/012



Title Holder: UCHECHUKWU ONYEMENAM

Old File Number: EBS/LU/AI/2096 New File Number: PAL/3314

Survey Plan No: HT/EB 134B/2009

Property Description: LAND AT CHUKWU UKPABI AMUZU IGBEAGU IN IZZI LOCAL GOVERNMENT AREA OF EBONYI STATE.

one hundred and  
STAMP DUTIES

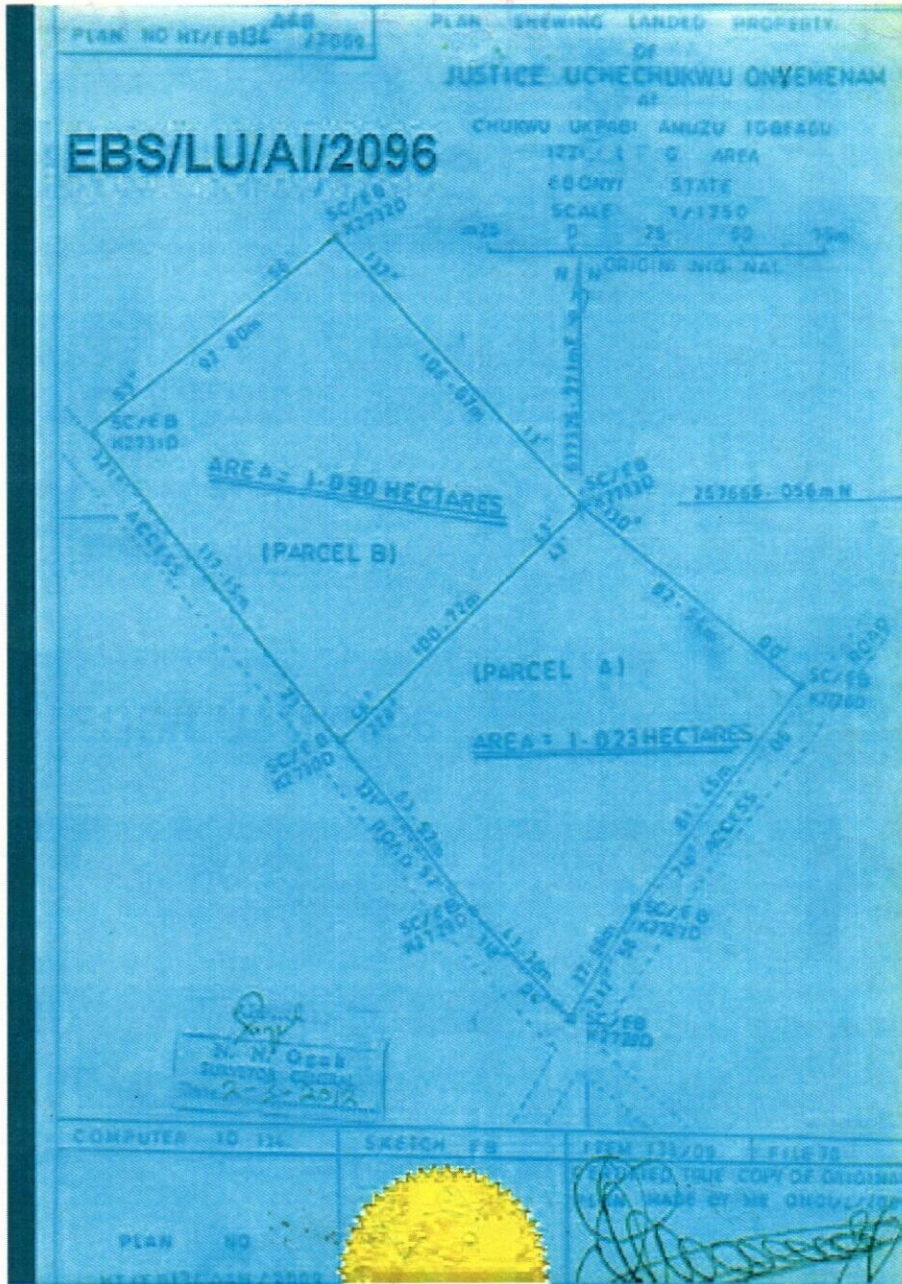

The within instrument in the opinion of the commissioner of stamp duties chargeable with the sum of **N100.00** and the duty thereon has been assessed accordingly.

*(Sgd) Obasi B.O*  
 Commissioner For Stamp Duties  
 0107321 OF 8/3/2012

This instrument was delivered for registration at **14:22 O'Clock** in the **AFTERNOON** on **29th August, 2012** and registered as No **100** at page **100** Volume **219** of the Ministry of Lands Registry in the Office at Abakaliki

*(Sgd) [Signature]*  
 Registrar of Deeds

**TRUE COPY**  
 REGISTRAR OF DEEDS



*paid at 14/8/2012*

**EBONYI LANDS INFORMATION MANAGEMENT SYSTEM**

**SURVEY DESCRIPTION OF LANDED PROPERTY OF PAL/3314**
**UCHECHUKWU ONYEMENAM**
**CHUKWU UKPABI AMUZU IGBEAGU IZZI**
**IZZI**

All that parcel of land at ..... in the .....

Local Government Area of the Ebonyi State of Nigeria, containing an Area of approximately

**10,900.00** Square Metres shown on Ebonyi State of Nigeria Survey Plan No.

**HT/EB134B/2009**

(Tracing No. .... ) the

boundaries of which are described below.

 Starting at concrete pillar marked **SC-EBK2733D** the coordinates of which are:

**257665.056** Metres North and **637325.771** Metres East of a concrete pillar marked

**NIG. NAT.** the origin of **NAT. ZERO** cadastral surveys. The boundaries run

in straight lines the bearings and lengths of which are as follows:

S/N	From	Bearing		Lengths in: M		To
		Degree (°)	Minute (')	Length		
	SC-EBK2733D	228	43	100.72		SC-EBK2730D
	SC-EBK2730D	321	23	117.15		SC-EBK2731D
	SC-EBK2731D	53	56	92.80		SC-EBK2732D
	SC-EBK2732D	137	13	108.62		SC-EBK2733D
<b>THE STARTING POINT</b>						

All property beacons are concrete pillars, all bearings and lengths approximate and all bearings are referred to Colony /True North.

 for Surveyor-General  
Ebonyi State of Nigeria

\*\*\*\*\*