

Sept/28/012

Nº 0001691



EBS/Lu/AI/1746

EBONYI STATE OF NIGERIA

No. 4

Vol: 231

PAGE 4

Certificate of Occupancy

LDR No:.....

File No: PAL/3560

This is to certify that NWOFE PHILIP NWACHUKWU of NO 8 OKEKE STREET, ABAKALIKI, EBONYI STATE. (hereinafter called the holder/holders) is/are granted a right of occupancy in respect of LANDED PROPERTY KNOWN AS PLOT NO 147 IN BLOCK NO. H INYIMAGU LAYOUT, ABAKALIKI IN ABAKALIKI L.G.A, EBONYI STATE. described in the Schedule and more particularly marked and delineated in the PLAN NO. CUO/EB 02/2001 attached to this certificate and thereon bordered or verged RED for the term of 99 (NINETY-NINE) year(s) from the 1ST JANUARY, 2012 subject to the provision of the LAND USE ACT, 1978 and to the provisions and conditions implied by virtue of the said Act and the Regulations for the time being in force made under the said Act and to the covenants and conditions herein contained.

- 1(a) RENT: N595.00 (FIVE HUNDRED AND NINETY-FIVE NAIRA) per annum.
- (b) The rent hereby reserved shall be revised at the end of every 5 (FIVE) year(s) of the term of this grant.
- (c) Buildings to the value of not less than N1,000,000.00 (ONE MILLION NAIRA) to the satisfaction and in accordance with plans approved by the A.P.A or such officer as the A.P.A may appoint.
- (d) Time within which such building(s) is/are to be erected and completed fit for occupation and use. Within 3 (THREE) year(s) from the date of commencement of the term of this certificate.
- (e) Purpose for which the land granted may be used: RESIDENTIAL

2. This certificate of occupancy is issued subject to the following Covenants and conditions being observed by the holder/holders:-

- (a) Not to erect or build or permit to be erected or built on the land hereby granted any buildings other than those covenanted to be erected by virtue of this certificate of occupancy and the regulations under the said Act not to make or permit to be made any addition or alteration to the said buildings to be erected except in accordance with plans and specification approved by the A.P.A of Ebonyi State of Nigeria or any other officer appointed by him.
- (b) To keep the exterior and interior of the buildings to be erected and the outbuilding and erections which may at any time during the term hereby created be erected on the land hereby granted and all additions to such buildings and outbuildings and the walls, fences and appurtenances thereof in good and tenantable repair and condition.
- (c) Not to use the building on the said land whether now erected hereafter thereon for any purpose other than
- (d) Not to alienate the right of Certificate of Occupancy hereby granted or any part thereof by sale, assignment, mortgage, transfer of possession, sublease, or bequest or otherwise howsoever without the consent of the GOVERNOR first had and obtained.
- (e) Not to permit anything to be used or done upon any part of the granted premises which shall be noxious, noisy or offensive or be of any inconvenience or annoyance to tenants or occupiers of premises adjoining or near thereto.
- (f) To maintain standards of accommodation and sanitary and living conditions conformable with standards obtaining in the neighbourhood.
- (g) To pay forthwith with or without demand to the DEPUTY DIRECTOR LAND or other persons appointed by him before the issue of this certificate, all survey fees, registration fees, and other charges due in respect of preparation and issue and registration of this certificate.
- (h) Paid an improvement premium of N00.00 (N/A)
- (i) To install and operate water borne sewage system within six months from the date the buildings erected on the plot are connected to piped water-supply.
- (j) To pay with or without demand on the first day of January of each year the rent reserved in these presents or any other rent as may be revised in future.

19/08/012

GIVEN under my hand this 17th day of May 2013

ARC. NWOGHA FRIDAY MOSES

COMMISSIONER FOR LANDS, SURVEY AND HOUSING EBONYI STATE OF NIGERIA

(By virtue of Powers to grant Certificate of Occupancy and Right of Occupancy delegated to him by the Governor, under Section 4(a) and (b) of the Land Use Edict (now Law) NO.2 of 1979 (as applicable in Ebonyi State), and Section 45 of the Land Use Act No.6 of 1978.

Signature of Holder / Holders Signature of Witness

Name of Witness Nwoie B. U Occupation of Witness Civil Service

Address Min. of Lands, Survey and Housing Abakaliki

5/08/013



Title Holder: NWOFE PHILIP NWACHUKWU

Old File Number: EBS/LU/AI/1746 New File Number: PAL/3560

Survey Plan No: CUO/EB 02/2001

NIGERIA
One Hundred
STAMP DUTIES

Property Description: LANDED PROPERTY KNOWN AS PLOT NO 147 IN BLOCK NO. H INYIMAGU LAYOUT, ABAKALIKI IN ABAKALIKI L.G.A, EBONYI STATE.

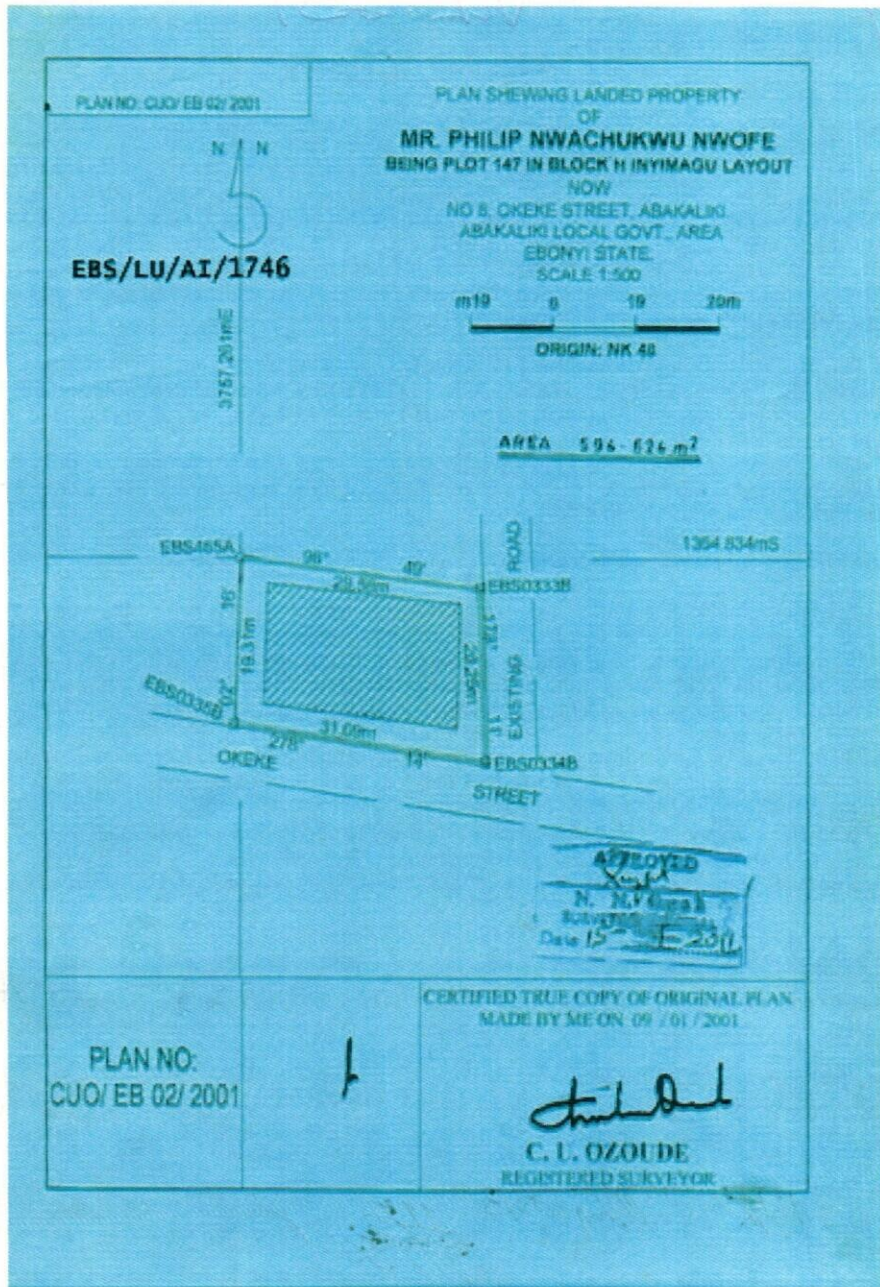

REGISTRY
SIGN
EBONYI

REGISTRY
SIGN
EBONYI

The within instrument in the opinion of the commissioner of stamp duties chargeable with the sum of N100.00 and the duty thereon has been assessed accordingly.

(Seal) *[Signature]*
Commissioner For Stamp Duties
RCR NO 084317 OF 20/04/2011

This instrument was delivered for registration at 9:33 O'Clock in the FORENOON on 4th September, 2012 and registered as No 4 at page 4 Volume 231 of the Ministry of Lands Registry in the Office at Abakaliki

[Signature]
Registrar of Deeds

CERTIFIED TRUE COPY
[Signature]
REGISTRAR OF DEEDS



[Handwritten] 5/8/12



EBONYI LANDS INFORMATION MANAGEMENT SYSTEM



SURVEY DESCRIPTION OF LANDED PROPERTY OF PAL /3560

PHILIP NWACHUKWU NWOFE



All that parcel of land at PLOT NO 147 IN BLOCK H in the ABAKALIKI Local Government Area of the Ebonyi State of Nigeria, containing an Area of approximately 594.624 Square Metres shown on Ebonyi State of Nigeria Survey Plan No. CUO/EB.Q2/2001 (Tracing No.) the boundaries of which are described below.

EBS 465A

Starting at concrete pillar marked the coordinates of which are: 1364.834 Metres South and 3757.261 Metres East of a concrete pillar marked NK 48 the origin of ABAKALIKI cadastral surveys. The boundaries run in straight lines the bearings and length of which are as follows:

S/N	From	Bearing		Lengths in: M		To
		Degree (°)	Minute (')	Length		
	EBS 465A	96	49	29.58		EBS 0333B
	EBS 0333B	178	11	20.25		EBS 0334B
	EBS 0334B	278	14	31.09		EBS 0335B
	EBS 0335B	02	16	19.31		EBS 465A
						THE STARTING POINT



All property beacons are concrete pillars, all bearing and length approximate and all bearings

[Signature]

FOR SURVEYOR - GENERAL
EBONYI STATE OF NIGERIA

are referred to National /True North.
