

Sept/196/012  
No 0001772



EB 8/LU/A/2104

EBONYI STATE OF NIGERIA

No. 30

A/SUR/LAW/175/11/2012/EB84  
Vol: 231 PAGE 30

Certificate of Occupancy

LDR No:.....

File No: PAL/3626

This is to certify that JONATHAN OKORONKWO of NO 7 AMASIRI STREET, ABAKALIKI (hereinafter called the holder/holders) is/are granted a right of occupancy in respect of LAND AT AMIKE ABA VILLAGE IN EBONYI LOCAL GOVERNMENT AREA OF EBONYI STATE described in the Schedule and more particularly marked and delineated in the PLAN NO. OTE/EB486/2010 attached to this certificate and thereon bordered or verged RED for the term of 99 (NINETY-NINE) year(s) from the 1ST JANUARY, 2012 subject to the provision of the LAND USE ACT, 1978 and to the provisions and conditions implied by virtue of the said Act and the Regulations for the time being in force made under the said Act and to the covenants and conditions herein contained.

- 1(a) RENT: N2,415.00 (TWO THOUSAND FOUR HUNDRED AND FIFTEEN NAIRA) per annum.
- (b) The rent hereby reserved shall be revised at the end of every 5 (FIVE) year(s) of the term of this grant.
- (c) Buildings to the value of not less than N1,000,000.00 (ONE MILLION NAIRA) to the satisfaction and in accordance with plans approved by the A.P.A or such officer as the A.P.A may appoint.
- (d) Time within which such building(s) is/are to be erected and completed fit for occupation and use. Within 3 (THREE) year(s) from the date of commencement of the term of this certificate.
- (e) Purpose for which the land granted may be used: RESIDENTIAL

2. This certificate of occupancy is issued subject to the following Covenants and conditions being observed by the holder/holders:-

- (a) Not to erect or build or permit to be erected or built on the land hereby granted any buildings other than those covenanted to be erected by virtue of this certificate of occupancy and the regulations under the said Act not to make or permit to be made any addition or alteration to the said buildings to be erected except in accordance with plans and specification approved by the A.P.A of Ebonyi State of Nigeria or any other officer appointed by him.
- (b) To keep the exterior and interior of the buildings to be erected and the outbuilding and erections which may at any time during the term hereby created be erected on the land hereby granted and all additions to such buildings and outbuildings and the walls, fences and appurtenances thereof in good and tenable repair and condition.
- (c) Not to use the building on the said land whether now erected or to be erected hereafter thereon for any purpose other than that specified in these presents.
- (d) Not to alienate the right of Certificate of Occupancy hereby granted or any part thereof by sale, assignment, mortgage, transfer of possession, sublease, or bequest or otherwise howsoever without the consent of the GOVERNOR first had and obtained.
- (e) Not to permit anything to be used or done upon any part of the granted premises which shall be noxious, noisy or offensive or be of any inconvenience or annoyance to tenants or occupiers of premises adjoining or near thereto.
- (f) To maintain standards of accommodation and sanitary and living conditions conformable with standards obtaining in the neighbourhood.
- (g) To pay forthwith with or without demand to the DIRECTOR LANDS or other persons appointed by him before the issue of this certificate, all survey fees, registration fees, and other charges due in respect of preparation and issue and registration of this certificate.
- (h) Paid an improvement premium of N0.00 (N/A)
- (i) To install and operate water borne sewage system within six months from the date the buildings erected on the plot are connected to piped water-supply.
- (j) To pay with or without demand on the first day of January of each year the rent reserved in these presents or any other rent as may be revised in future.

GIVEN under my hand this 22nd day of October 2012

ARC. NWOGHA FRIDAY MOSES

COMMISSIONER FOR LANDS, SURVEY AND HOUSING EBONYI STATE OF NIGERIA

(By virtue of Powers to grant Certificate of Occupancy and Right of Occupancy delegated to him by the Governor, under Section 4(a) and (b) of the Land Use Edict (now Law) NO.2 of 1979 (as applicable in Ebonyi State), and Section 45 of the Land Use Act No.6 of 1978.

Signature of Holder / Holders ..... Signature of Witness .....

Name of Witness Nwoie B. U Occupation of Witness Civil Service

Address Min. of Lands, Survey and Housing Abakaliki

11/01/013



Title Holder: JONATHAN OKORONKWO

Old File Number: EBS/LU/AI/2104 - New File Number: PAL/3626

Survey Plan No: OTE/EB486/2010

Property Description: LAND AT AMIKE ABA VILLAGE IN EBONYI LOCAL GOVERNMENT AREA OF EBONYI STATE

one hundred  
Naira

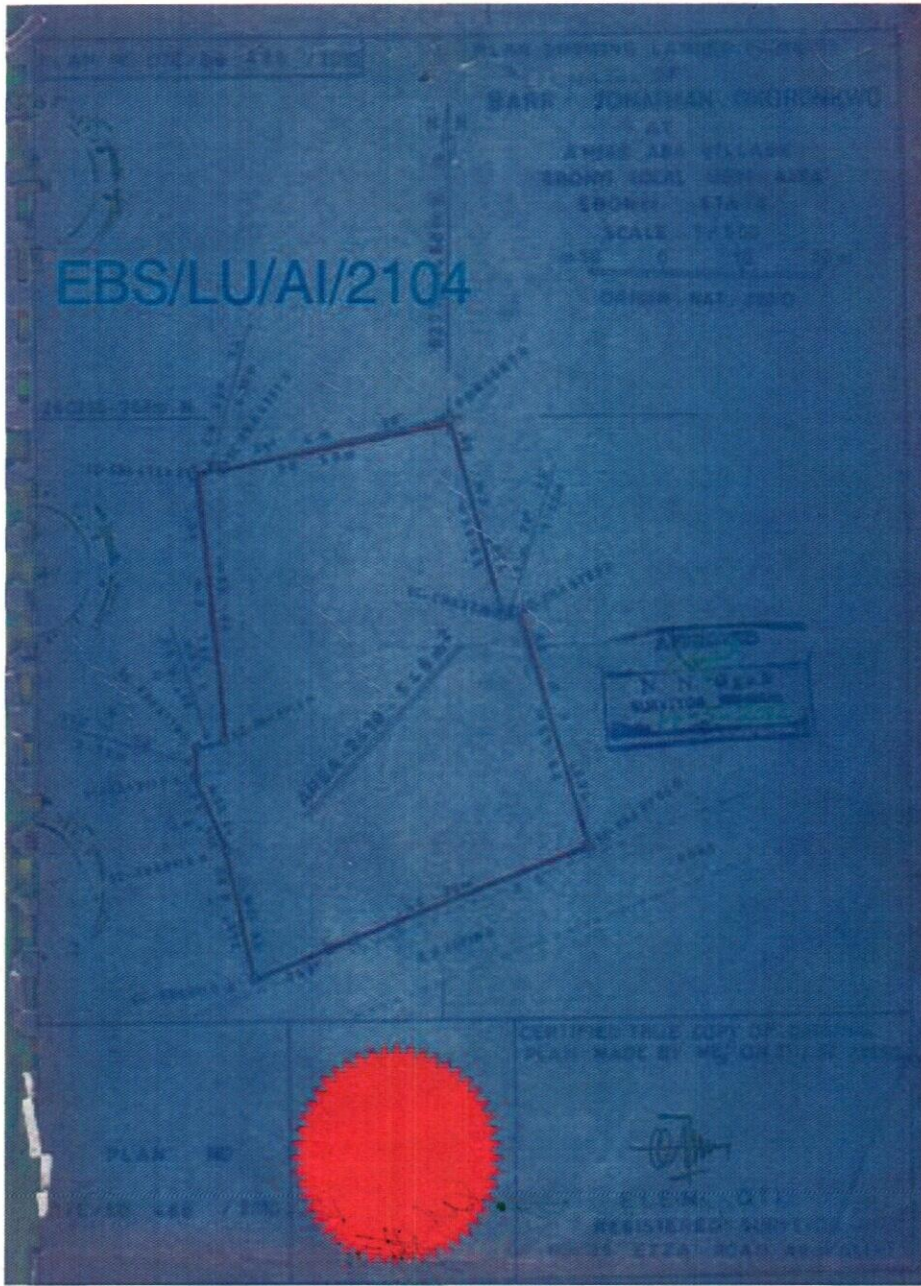

The within instrument in the opinion of the commissioner of stamp duties chargeable the sum of N100.00 and the duty thereon has been assessed accordingly.

*Osasi B-U*

Commissioner For Stamp Duties  
0182334 OF 11/7/12

This instrument was delivered for registration at 15:22 O'Clock in the AFTERNOON on 25th September, 2012 and registered as No 30 at page 30 Volume 131 of the Ministry of Lands Registry in the Office at Abakaliki.

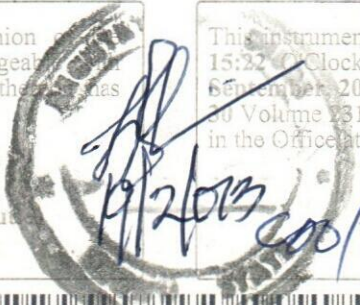

*[Signature]*  
Registrar of Deeds



CERTIFIED TRUE COPY  
*[Signature]*  
REGISTRAR OF DEEDS

*A. H.*  
11/01/2013



## EBONYI LANDS INFORMATION MANAGEMENT SYSTEM



### SURVEY DESCRIPTION OF LANDED PROPERTY OF PAL/3626

-----  
**JONATHAN OKORONKWO**  
 -----

All that parcel of land at AMIKE-ABA VILLAGE in the EBONYI

Local Government Area of the Ebonyi State of Nigeria, containing an Area of approximately

2410.545 Square Metres shown on Ebonyi State of Nigeria Survey Plan No.

**OTE/EB 486/2010**

(Tracing No. -) the

boundaries of which are described below.

Starting at concrete pillar marked **PBK 0007A** the coordinates of which are:

260395.768 Metres North and 627701.468 Metres East of a concrete pillar marked

NIG. NAT the origin of NAT. ZERO cadastral surveys. The boundaries run

in straight lines the bearings and length of which are as follows:

S/N	From	Bearing		Lengths in: M		To
		Degree (°)	Minute (')	Length		
	<b>PBK0007A</b>	<b>166</b>	<b>00</b>	<b>25.75</b>		<b>SC-EBA9728D</b>
	SC-EBA9728D	79	30	1.20		SC-EBA9729D
	SC-EBA9729D	161	00	29.45		SC-EBA9730D
	SC-EBA9730D	249	30	42.20		SC-EBA8115A
	SC-EBA8115A	345	00	16.00		SC-EBA8116A
	SC-EBA8116A	334	30	10.35		SC-EBA8117A
	SC-EBA8117A	354	00	3.75		SC-EBA8118A
	SC-EBA8118A	80	30	3.15		SC-EBA8119A
	SC-EBA8119A	354	00	33.50		SC-EBA4750E
	SC-EBA4750E	790	14	4.80		SC-EBA4751E
	SC-EBA4751E	81	20	30.50		PBK0007A
			THE	STARTING		POINT

All property beacons are concrete pillars, all bearing and length approximate and all bearings are referred to National /True North.

*[Signature]*  
**For Surveyor-General**

Ebonyi State of Nigeria

\*\*\*\*\*