

No V/29/012
Nº 0001936



EB9/LU/A1/1838

EBONYI STATE OF NIGERIA

No. 84

Vol: 231

PAGE 84

Certificate of Occupancy

LDR No:.....

File No: PAL/4037

This is to certify that **JOSEPH CHUKWUEKWU OFORAH** of **NO.10C ODUNUKWE STREET, ABAKALIKI, EBONYI STATE.** (hereinafter called the holder/holders) is/are granted a right of occupancy in respect of **LAND AT AGUOGBORIGA NKALEKE, ABAKALIKI IN ABAKALIKI LOCAL GOVERNMENT AREA.** described in the Schedule and more particularly marked and delineated in the **PLAN NO. OTE/EB917/2003** attached to this certificate and thereon bordered or verged **RED** for the term of **99 (NINETY-NINE)** year(s) from the **1ST JANUARY, 2012** subject to the provision of the **LAND USE ACT, 1978** and to the provisions and conditions implied by virtue of the said Act and the Regulations for the time being in force made under the said Act and to the covenants and conditions herein contained.

- 1(a) RENT: **N965.00 (NINE HUNDRED AND SIXTY-FIVE NAIRA)** per annum.
- (b) The rent hereby reserved shall be revised at the end of every **5 (FIVE)** year(s) of the term of this grant.
- (c) Buildings to the value of not less than **N1,000,000.00 (ONE MILLION NAIRA)** to the satisfaction and in accordance with plans approved by the **A.P.A** or such officer as the **A.P.A** may appoint.

(d) Time within which such building(s) is/are to be erected and completed fit for occupation and use. Within **3 (THREE)** year(s) from the date of commencement of the term of this certificate.

(e) Purpose for which the land granted may be used: **RESIDENTIAL**

2. This certificate of occupancy is issued subject to the following Covenants and conditions being observed by the holder/holders:-

- (a) Not to erect or build or permit to be erected or built on the land hereby granted any buildings other than those covenanted to be erected by virtue of this certificate of occupancy and the regulations under the said Act not to make or permit to be made any addition or alteration to the said buildings to be erected except in accordance with plans and specification approved by the **A.P.A** of Ebonyi State of Nigeria or any other officer appointed by him.
- (b) To keep the exterior and interior of the buildings to be erected and the outbuilding and erections which may at any time during the term hereby created be erected on the land hereby granted and all additions to such buildings and outbuildings and the walls, fences and appurtenances thereof in good and tenantable repair and condition.
- (c) Not to use the building on the said land whether now erected or to be erected hereafter thereon for any purpose other than that specified in these presents.
- (d) Not to alienate the right of Certificate of Occupancy hereby granted or any part thereof by sale, assignment, mortgage, transfer of possession, sublease, or bequest or otherwise howsoever without the consent of the **GOVERNOR** first had and obtained.
- (e) Not to permit anything to be used or done upon any part of the granted premises which shall be noxious, noisy or offensive or be of any inconvenience or annoyance to tenants or occupiers of premises adjoining or near thereto.
- (f) To maintain standards of accommodation and sanitary and living conditions conformable with standards obtaining in the neighbourhood.
- (g) To pay forthwith with or without demand to the **DIRECTOR LANDS** or other persons appointed by him before the issue of this certificate, all survey fees, registration fees, and other charges due in respect of preparation and issue and registration of this certificate.
- (h) Paid an improvement premium of **N0.00 (N/A)**
- (i) To install and operate water borne sewage system within six months from the date the buildings erected on the plot are connected to piped water-supply.
- (j) To pay with or without demand on the first day of January of each year the rent reserved in these presents or any other rent as may be revised in future.

GIVEN under my hand this 11th day of Dec 2012

ARC. NWOGHA FRIDAY MOSES

COMMISSIONER FOR LANDS, SURVEY AND HOUSING EBONYI STATE OF NIGERIA

(By virtue of Powers to grant Certificate of Occupancy and Right of Occupancy delegated to him by the Governor, under Section 4(a) and (b) of the Land Use Edict (now Law) N0.2 of 1979 (as applicable in Ebonyi State), and Section 45 of the Land Use Act No.6 of 1978.

Signature of Holder / Holders Signature of Witness

Name of Witness ONELE T. C Occupation of Witness CIVIL SERVICE

Address MIN. OF LANDS, SURVEY & HOUSING, ABAKALIKI

06/02/013



12/11/013

Title Holder: JOSEPH CHUKWUJEKWU OFORAH

Old File Number: EBS/LU/AI/1838 New File Number: PAL/4037

Survey Plan No: OTE/EB917/2003

Property Description: LAND AT AGUOGBORIGA NKALEKE, ABAKALIKI IN ABAKALIKI LOCAL GOVERNMENT AREA.

Stamp: **STAMP DUTIES**
One hundred naira
VIENNA

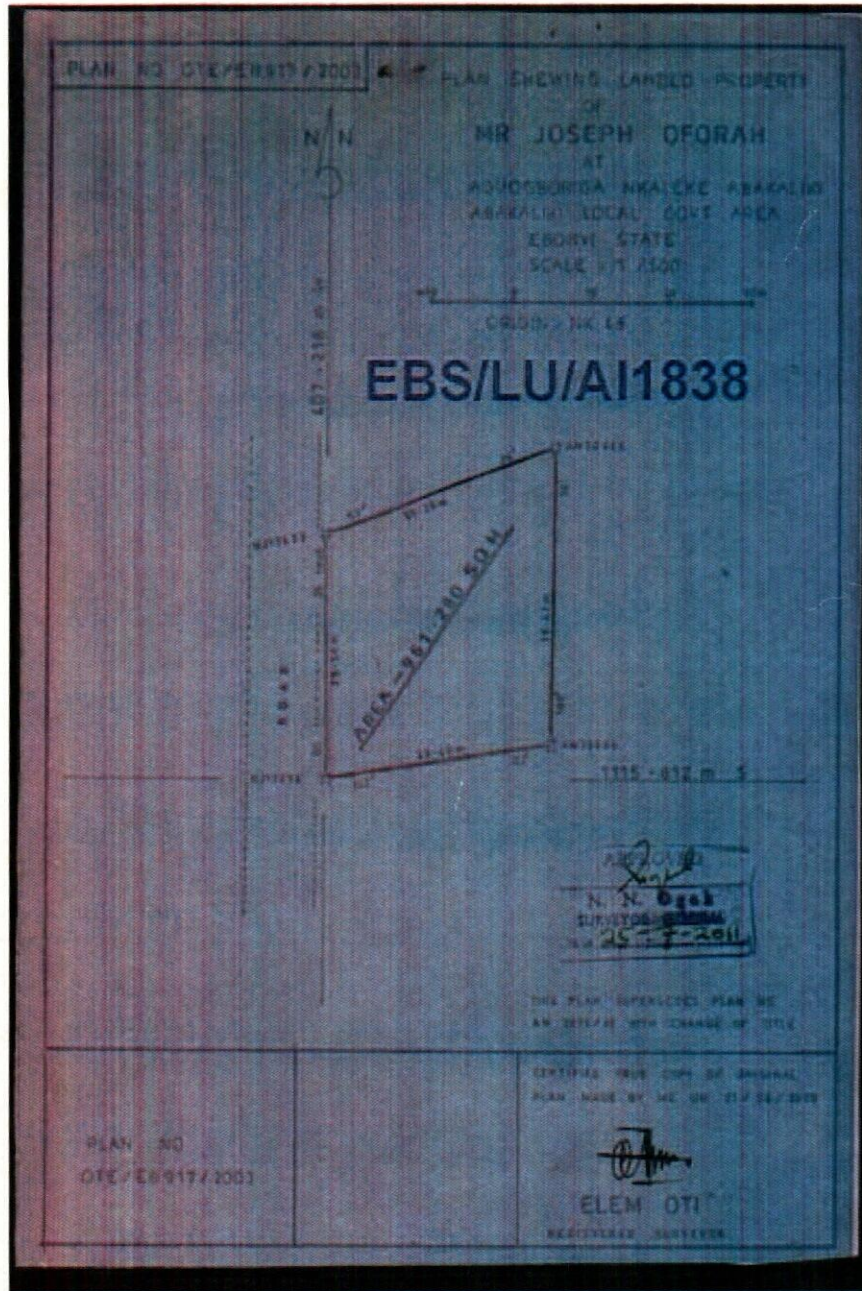

The within instrument in the opinion of the commissioner of stamp duties chargeable with the sum of N100.00 and the duty thereon has been assessed accordingly.

(Sgd) Obasin B O

Commissioner For Stamp Duties
0128561 OF 25/6/2012

This instrument was delivered for registration at 13:31 O'Clock in the AFTERNOON on 5th November, 2012 and registered as No 84 at page 84 Volume 231 of the Ministry of Lands Registry in the Office at Abakaliki

(Sgd) Joseph Chukwujeckwu Oforah

Registrar of Deeds

Stamp: **REGISTRY OF DEEDS**
copy
Registrar of Deeds



7/2/073



EBONYI LANDS INFORMATION MANAGEMENT SYSTEM



SURVEY DESCRIPTION OF LANDED PROPERTY OF PAL/4037

JOSEPH CHUKWUJEKWU OFORAH

All that parcel of land at **AGUOGBORIGA NKALEKE** in the **ABAKALIKI**

Local Government Area of the Ebonyi State of Nigeria, containing an Area of approximately

961.280 Square Metres shown on Ebonyi State of Nigeria Survey Plan No.

OTE/EB917/2003 (Tracing No.) the

boundaries of which are described below.

Starting at concrete pillar marked **BJ17636** the coordinates of which are:

1115.812 Metres South and **407.218** Metres West of a concrete pillar marked

NK 48 the origin of **ABAKALIKI** cadastral surveys. The boundaries run

in straight lines the bearings and length of which are as follows:

S/N	From	Bearing		Lengths in: M	
		Degree (°)	Minute (')	Length	To
	BJ 17636	00	25	29.54	BJ 17637
	BJ 17637	69	24	31.28	AN 30666
	AN 30666	180	36	36.47	AN 30665
	AN 30665	262	02	29.40	BJ 17636

All property beacons are concrete pillars, all bearing and length approximate and all bearings are referred to National / True North.

[Signature]
for Surveyor-General
Ebonyi State of Nigeria
