

Dec/87/012

A/SUR/NO/28/10/2014/ESL, EBS/LU/AT/1196

No 0001840

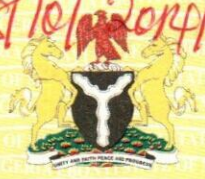

EBONYI STATE OF NIGERIA

No. 25

Vol: 243 PAGE 25

Certificate of Occupancy

LDR No:.....

File No: PAL/4198

This is to certify that MENANKITI BEATRICE of NO 26A NKWOGU STREET, ABAKALIKI, EBONYI STATE. (hereinafter called the holder/holders) is/are granted a right of occupancy in respect of PROPERTY KNOWN AS PLOT NO 12 IN BLOCK 'F' NDIAGU LAYOUT ABAKALIKI IN ABAKALIKI L.G.A, EBONYI STATE. described in the Schedule and more particularly marked and delineated in the PLAN NO. HT/EB 642/2009 attached to this certificate and thereon bordered or verged RED for the term of 99 (NINETY-NINE) year(s) from the 1ST JANUARY, 2012 subject to the provision of the LAND USE ACT, 1978 and to the provisions and conditions implied by virtue of the said Act and the Regulations for the time being in force made under the said Act and to the covenants and conditions herein contained.

- 1(a) RENT: N1,035.00 (ONE THOUSAND AND THIRTY-FIVE NAIRA) per annum.
- (b) The rent hereby reserved shall be revised at the end of every 5 (FIVE) year(s) of the term of this grant.
- (c) Buildings to the value of not less than N1,000,000.00 (ONE MILLION NAIRA) to the satisfaction and in accordance with plans approved by the A.P.A or such officer as the A.P.A may appoint.
- (d) Time within which such building(s) is/are to be erected and completed fit for occupation and use. Within 3 (THREE) year(s) from the date of commencement of the term of this certificate.
- (e) Purpose for which the land granted may be used: RESIDENTIAL

2. This certificate of occupancy is issued subject to the following Covenants and conditions being observed by the holder/holders:-

- (a) Not to erect or build or permit to be erected or built on the land hereby granted any buildings other than those covenanted to be erected by virtue of this certificate of occupancy and the regulations under the said Act not to make or permit to be made any addition or alteration to the said buildings to be erected except in accordance with plans and specification approved by the A.P.A of Ebonyi State of Nigeria or any other officer appointed by him.
- (b) To keep the exterior and interior of the buildings to be erected and the outbuilding and erections which may at any time during the term hereby created be erected on the land hereby granted and all additions to such buildings and outbuildings and the walls, fences and appurtenances thereof in good and tenantable repair and condition.
- (c) Not to use the building on the said land whether now erected or to be erected hereafter thereon for any purpose other than that specified in these presents.
- (d) Not to alienate the right of Certificate of Occupancy hereby granted or any part thereof by sale, assignment, mortgage, transfer of possession, sublease, or bequest or otherwise howsoever without the consent of the GOVERNOR first had and obtained.
- (e) Not to permit anything to be used or done upon any part of the granted premises which shall be noxious, noisy or offensive or be of any inconvenience or annoyance to tenants or occupiers of premises adjoining or near thereto.
- (f) To maintain standards of accommodation and sanitary and living conditions conformable with standards obtaining in the neighbourhood.
- (g) To pay forthwith with or without demand to the DIRECTOR LANDS or other persons appointed by him before the issue of this certificate, all survey fees, registration fees, and other charges due in respect of preparation and issue and registration of this certificate.
- (h) Paid an improvement premium of N00.00 (NIL)
- (i) To install and operate water borne sewage system within six months from the date the buildings erected on the plot are connected to piped water-supply.
- (j) To pay with or without demand on the first day of January of each year the rent reserved in these presents or any other rent as may be revised in future.

GIVEN under my hand this 29th day of August, 2014

ARC. NWOGHA FRIDAY MOSES

COMMISSIONER FOR LANDS, SURVEY AND HOUSING EBONYI STATE OF NIGERIA

(By virtue of Powers to grant Certificate of Occupancy and Right of Occupancy delegated to him by the Governor, under Section 4(a) and (b) of the Land Use Edict (now Law) NO.2 of 1979 (as applicable in Ebonyi State), and Section 45 of the Land Use Act No.6 of 1978.

Signature of Holder / Holders Signature of Witness

Name of Witness Nworie B. U Occupation of Witness Civil Service

Address Min. of Lands, Survey and Housing Abakaliki

11/12/2014



Title Holder: MENANKITI BEATRICE

Old File Number: EBS/LU/AI/1196 New File Number: PAL/4198

Survey Plan No: HT/EB 642/2009

Property Description: PROPERTY KNOWN AS PLOT NO 12 IN BLOCK 'F' NDIAGU LAYOUT ABAKALIKI IN ABAKALIKI L.G.A, EBONYI STATE.

NIGERIA
One hundred
STAMP hours
OUTSIDE

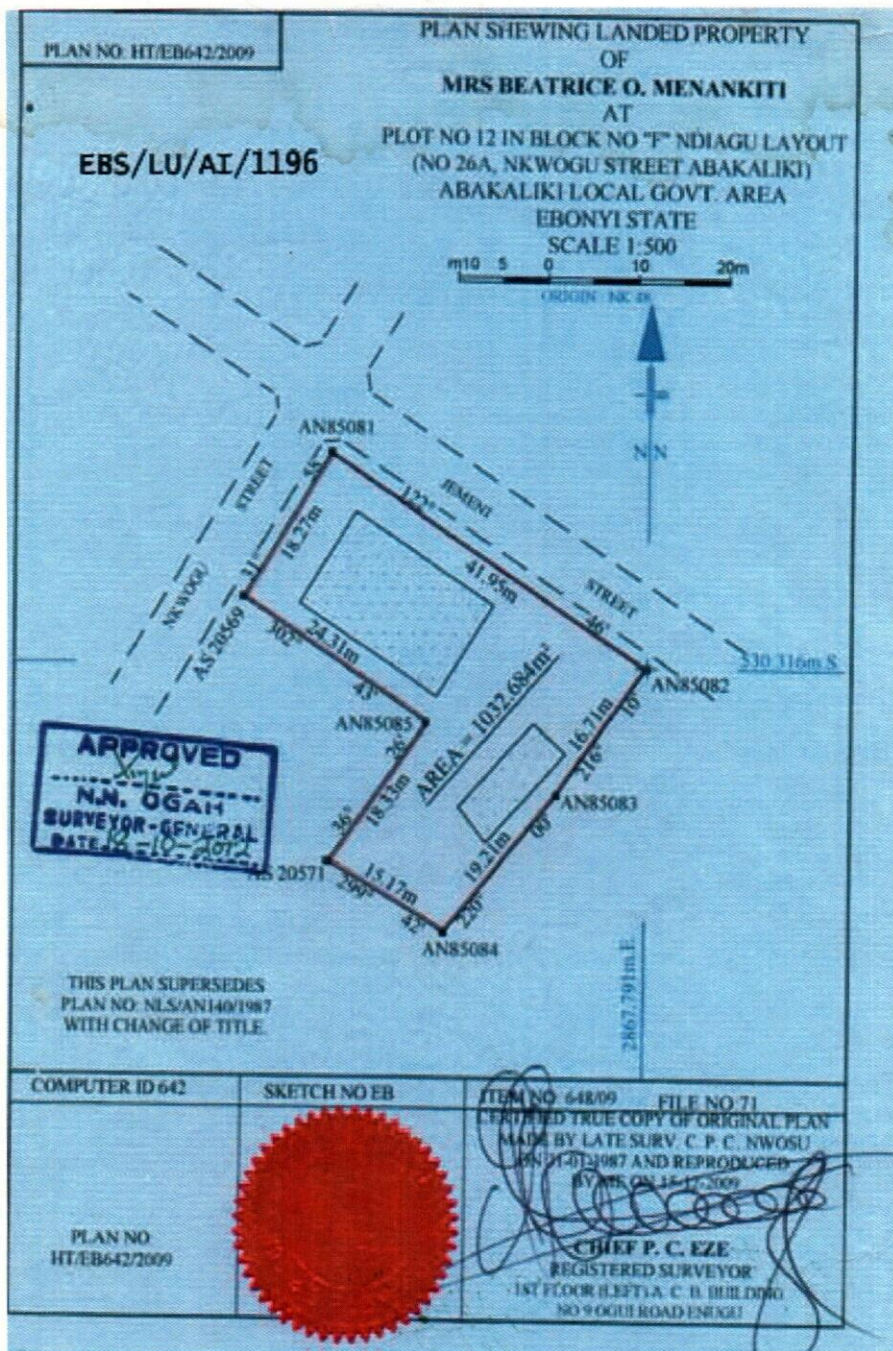

REGISTRAR
EBONYI

REGISTRAR
EBONYI

The within instrument in the opinion of the commissioner of stamp duties chargeable with the sum of N100.00 and the duty thereon has been assessed accordingly.

(sgd) Ogayi m.o
Commissioner For Stamp Duties
RCR NO 0216752 OF 11/10/2012

This instrument was delivered for registration at 11:2 O'Clock in the FORENOON on 6th December, 2012 and registered as No 25 at page 25 Volume 243 of the Ministry of Lands Registry in the Office at Abakaliki

Registrar of Deeds

CERTIFIED TRUE COPY
REGISTRAR OF DEEDS



PAL/4198
18/12/2015



EBONYI LANDS INFORMATION MANAGEMENT SYSTEM

SURVEY DESCRIPTION OF LANDED PROPERTY OF PAL/4198

MRS. BEATRICE O. MENANKITI

 All that parcel of land at **PLOT NO. 12 BLOCK NO. "F" NDIAGU LAYOUT** in the **ABAKALIKI**

 Local Government Area of the Ebonyi State of Nigeria, containing an Area of approximately **1032.684** Square Meters shown on Ebonyi State of Nigeria

 Survey Plan No. **HT/EB 642/2009** (Tracing No:.....) the

boundaries of which are described below.

 Starting at concrete pillar marked **AN 85085** the coordinates of which are:

530.316 Meters South and **2867.791** Meter East of a concrete pillar marked

NK 48 the Origin of **ABAKALIKI** Cadastral surveys.

The boundaries run in straight lines the bearings and lengths of which are as follows:

S/N	From	Bearing		Lengths in: M	
		Degree(^o)	Minute(')	Length	To
	AN 85082	216^o	10'	16.71m	AN 85083
	AN 85083	220^o	00'	19.21m	AN 85084
	AN 85084	299^o	42'	15.17m	AS 20571
	AS 20571	36^o	26'	18.33m	AN 85085
	AN 85085	302^o	43'	24.31m	AS 20569
	AS 20569	31^o	58'	18.27m	AN 85081
	AN 85081	122^o	46'	41.95m	AN 85082

THE STARTING POINT

All property beacons are concrete pillars, all bearings and lengths approximate and all bearings are referred to National/True North.

 For Surveyor-General
 Ebonyi State of Nigeria

ELIMS® BEACON CAPTURE TEMPLATE (Main Page)