

Marksslow

Nº 0002407



EB8/L4/A1/2500

EBONYI STATE OF NIGERIA

No. 9

Vol: 275

PAGE 9

Certificate of Occupancy

LDR No:.....

File No: PAL/5940

This is to certify that OKPANUM SUNDAY of NO 6 OWA STREET KPIRIKPIRI ABAKALIKI, EBONYI STATE (hereinafter called the holder/holders) is/are granted a right of occupancy in respect of PLOT AT KPIRIKPIRI LAYOUT (OWA STREET) ABAKALIKI, EBONYI STATE described in the Schedule and more particularly marked and delineated in the PLAN NO. HT/EB69/2003 attached to this certificate and thereon bordered or verged RED for the term of 99 (NINETY-NINE) year(s) from the 1ST JANUARY, 2014 subject to the provision of the LAND USE ACT, 1978 and to the provisions and conditions implied by virtue of the said Act and the Regulations for the time being in force made under the said Act and to the covenants and conditions herein contained.

- 1(a) RENT: N1,175.00 (ONE THOUSAND ONE HUNDRED AND SEVENTY FIVE NAIRA) per annum.
(b) The rent hereby reserved shall be revised at the end of every 5 (FIVE) year(s) of the term of this grant.
(c) Buildings to the value of not less than N1,000,000.00 (ONE MILLION) to the satisfaction and in accordance with plans approved by the A.P.A or such officer as the A.P.A may appoint.
(d) Time within which such building(s) is/are to be erected and completed fit for occupation and use. Within 3 (THREE) year(s) from the date of commencement of the term of this certificate.
(e) Purpose for which the land granted may be used: RESIDENTIAL

- 2. This certificate of occupancy is issued subject to the following Covenants and conditions being observed by the holder/holders:-
(a) Not to erect or build or permit to be erected or built on the land hereby granted any buildings other than those covenanted to be erected by virtue of this certificate of occupancy and the regulations under the said Act not to make or permit to be made any addition or alteration to the said buildings to be erected except in accordance with plans and specification approved by the A.P.A of Ebonyi State of Nigeria or any other officer appointed by him.
(b) To keep the exterior and interior of the buildings to be erected and the outbuilding and erections which may at any time during the term hereby created be erected on the land hereby granted and all additions to such buildings and outbuildings and the walls, fences and appurtenances thereof in good and tenantable repair and condition.
(c) Not to use the building on the said land whether now erected or to be erected hereafter thereon for any purpose other than that specified in these presents.
(d) Not to alienate the right of Certificate of Occupancy hereby granted or any part thereof by sale, assignment, mortgage, transfer of possession, sublease, or bequest or otherwise howsoever without the consent of the GOVERNOR first had and obtained.
(e) Not to permit anything to be used or done upon any part of the granted premises which shall be noxious, noisy or offensive or be of any inconvenience or annoyance to tenants or occupiers of premises adjoining or near thereto.
(f) To maintain standards of accommodation and sanitary and living conditions conformable with standards obtaining in the neighbourhood.
(g) To pay forthwith with or without demand to the DIRECTOR LANDS or other persons appointed by him before the issue of this certificate, all survey fees, registration fees, and other charges due in respect of preparation and issue and registration of this certificate.
(h) Paid an improvement premium of N00.00 (NOT APPLICABLE)
(i) To install and operate water borne sewage system within six months from the date the buildings erected on the plot are connected to piped water-supply.
(j) To pay with or without demand on the first day of January of each year the rent reserved in these presents or any other rent as may be revised in future.

11/04/14

GIVEN under my hand this 3rd day of April 2014

ARC. NWOGHA FRIDAY MOSES
COMMISSIONER FOR LANDS, SURVEY AND HOUSING EBONYI STATE OF NIGERIA

(By virtue of Powers to grant Certificate of Occupancy and Right of Occupancy delegated to him by the Governor, under Section 4(a) and (b) of the Land Use Edict (now Law) NO.2 of 1979 (as applicable in Ebonyi State), and Section 45 of the Land Use Act No.6 of 1978.

Signature of Holder / Holders ..... Signature of Witness .....

Name of Witness LGWUNBA RITA Occupation of Witness CIVIL SERVANT

Address MINISTRY OF LANDS SURVEY AND HOUSING ABAKALIKI

10/04/14





Title Holder: OKPANUM SUNDAY

Old File Number: EBS/LU/AI/2500 New File Number: PAL/5940

Survey Plan No: HT/EB69/2003

Property Description: PLOT AT KPIRIKPIRI LAYOUT (OWA STREET) ABAKALIKI, EBONYI STATE

NIGERIA  
ONE HUNDRED  
STAMP DUTIES

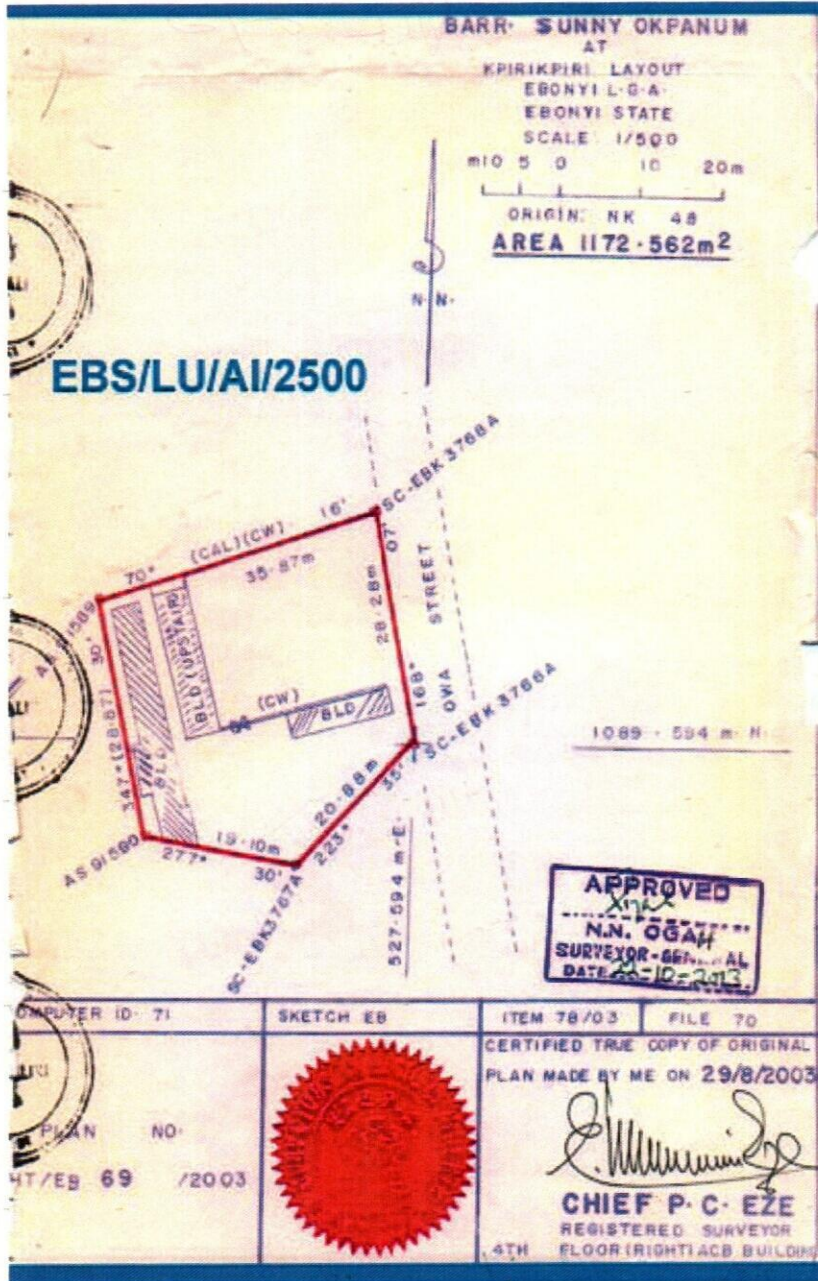

REGISTRAR  
APAKALIKI  
SIGA  
EBONYI

REGISTRAR  
APAKALIKI  
SIGA  
EBONYI

The within instrument in the opinion of the commissioner of stamp duties chargeable with the sum of N100.00 and the duty thereon has been assessed accordingly.

*Csgd Obasi B.O*

Commissioner For Stamp Duties  
RCR NO 0318575 OF 31/10/013

This instrument was delivered for registration at 12:2 O'Clock in the AFTERNOON on 10th March, 2014 and registered as No 9 at page 9 Volume 275 of the Ministry of Lands Registry in the Office at Abakaliki

REGISTRAR  
APAKALIKI  
SIGA  
EBONYI

*[Signature]*  
Registrar of Deeds

CERTIFIED TRUE COPY  
*[Signature]*  
REGISTRAR OF DEEDS



*[Signature]* 10/4/04





**EBONYI LANDS INFORMATION MANAGEMENT SYSTEM**



**SURVEY DESCRIPTION OF LANDED PROPERTY OF** PAL/5940

**BARR. SUNDAY OKPANUM**

**KPIRIKPIRI LAYOUT** **EBONYI**

All that parcel of land belonging in the

Local Government Area of the Ebonyi State of Nigeria, containing an Area of approximately

**1172.562** Square Metres shown on Ebonyi State of Nigeria Survey Plan No.

**HT/EB 69/2003** (Tracing No. ) the

boundaries of which are described below.

Starting at concrete pillar marked **SC/EBK 3766A** the coordinates of which are:

**1089.594** Metres North and **527.594** Metres East of a concrete pillar marked

**NK 48** the origin of **ABAKALIKI** cadastral surveys. The boundaries run

in straight lines the bearings and length of which are as follows:

S/N	From	Bearing		Lengths in: M		To
		Degree	Minute (')	Length		
	SC/EBK 3766A	223	35	20.88		SC/EBK 3767A
	SC/EBK 3767A	227	30	19.10		AS 91590
	AS 91590	347	30	28.87		AS 91589
	AS 91589	70	16	35.87		SC/EBK 3768A
	SC/EBK 3768A	168	07	28.28		SC/EBK 3766A
			THE	STARTING		POINT

All property beacons are concrete pillars, all bearing and length approximate and all bearings are referred to National /True North.

FOR SURVEYOR - GENERAL  
EBONYI STATE OF NIGERIA

\*\*\*\*\*