



EBONYI STATE OF NIGERIA

APR 16/10/14 No. 13

Vol: 198

EPSS/LUL/1K/15
PAGE 13

Certificate of Occupancy

LDR No:.....

File No: PAL/6239

This is to certify that ONWUDIWE EMEKA CHRIS of NO 2 ANAETO ONWUDIWE CLOSE, UPPER NORTH FIVE TRANS EKULU, ENUGU, ENUGU STATE (hereinafter called the holder/holders) is/are granted a right of occupancy in respect of PLOT AT OHANKWU VILLAGE NDUFU ALIKE IKWO, IKWO LOCAL GOVERNMENT AREA, EBONYI STATE described in the Schedule and more particularly marked and delineated in the PLAN NO. HT/EB 102/2012 attached to this certificate and thereon bordered or verged RED for the term of 99 (NINETY-NINE) year(s) from the 1ST JANUARY, 2014 subject to the provision of the LAND USE ACT, 1978 and to the provisions and conditions implied by virtue of the said Act and the Regulations for the time being in force made under the said Act and to the covenants and conditions herein contained.

- 1(a) RENT: N1,845.00 (ONE THOUSAND EIGHT HUNDRED AND FORTY FIVE NAIRA) per annum.
- (b) The rent hereby reserved shall be revised at the end of every 5 (FIVE) year(s) of the term of this grant.
- (c) Buildings to the value of not less than N1,000,000.00 (ONE MILLION NAIRA) to the satisfaction and in accordance with plans approved by the A.P.A or such officer as the A.P.A may appoint.
- (d) Time within which such building(s) is/are to be erected and completed fit for occupation and use. Within 3 (THREE) year(s) from the date of commencement of the term of this certificate.
- (e) Purpose for which the land granted may be used: RESIDENTIAL

2. This certificate of occupancy is issued subject to the following Covenants and conditions being observed by the holder/holders:-

- (a) Not to erect or build or permit to be erected or built on the land hereby granted any buildings other than those covenanted to be erected by virtue of this certificate of occupancy and the regulations under the said Act not to make or permit to be made any addition or alteration to the said buildings to be erected except in accordance with plans and specification approved by the A.P.A of Ebonyi State of Nigeria or any other officer appointed by him.
- (b) To keep the exterior and interior of the buildings to be erected and the outbuilding and erections which may at any time during the term hereby created be erected on the land hereby granted and all additions to such buildings and outbuildings and the walls, fences and appurtenances thereof in good and tenable repair and condition.
- (c) Not to use the building on the said land whether now erected or to be erected hereafter thereon for any purpose other than that specified in these presents.
- (d) Not to alienate the right of Certificate of Occupancy hereby granted or any part thereof by sale, assignment, mortgage, transfer of possession, sublease, or bequest or otherwise howsoever without the consent of the GOVERNOR first had and obtained.
- (e) Not to permit anything to be used or done upon any part of the granted premises which shall be noxious, noisy or offensive or be of any inconvenience or annoyance to tenants or occupiers of premises adjoining or near thereto.
- (f) To maintain standards of accommodation and sanitary and living conditions conformable with standards obtaining in the neighbourhood.
- (g) To pay forthwith with or without demand to the DIRECTOR LANDS or other persons appointed by him before the issue of this certificate, all survey fees, registration fees, and other charges due in respect of preparation and issue and registration of this certificate.
- (h) Paid an improvement premium of N00.00 (NOT APPLICABLE)
- (i) To install and operate water borne sewage system within six months from the date the buildings erected on the plot are connected to piped water-supply.
- (j) To pay with or without demand on the first day of January of each year the rent reserved in these presents or any other rent as may be revised in future.

10/7/14

GIVEN under my hand this 25th day of May 2014

ARC. NWOGHA FRIDAY MOSES
COMMISSIONER FOR LANDS, SURVEY AND HOUSING EBONYI STATE OF NIGERIA

(By virtue of Powers to grant Certificate of Occupancy and Right of Occupancy delegated to him by the Governor, under Section 4(a) and (b) of the Land Use Edict (now Law) N0.2 of 1978 (as applicable in Ebonyi State), and Section 45 of the Land Use Act No.6 of 1978.

Signature of Holder / Holders Signature of Witness

Name of Witness UGWUMBA RITA Occupation of Witness CIVIL SERVANT

Address MINISTRY OF LANDS, SURVEY AND HOUSING ABAKALIK



25/6/14

Title Holder: ONWUDIWE EMEKA CHRIS

Old File Number: EBS/LU/IK/5 New File Number: PAL/6239

Survey Plan No: HT/EB 102/2012

Property Description: PLOT AT OHANKWU VILLAGE NDUFU ALIKE IKWO, IKWO LOCAL GOVERNMENT AREA, EBONYI STATE

NIGERIA
One hundred names
STAMP DUTIES

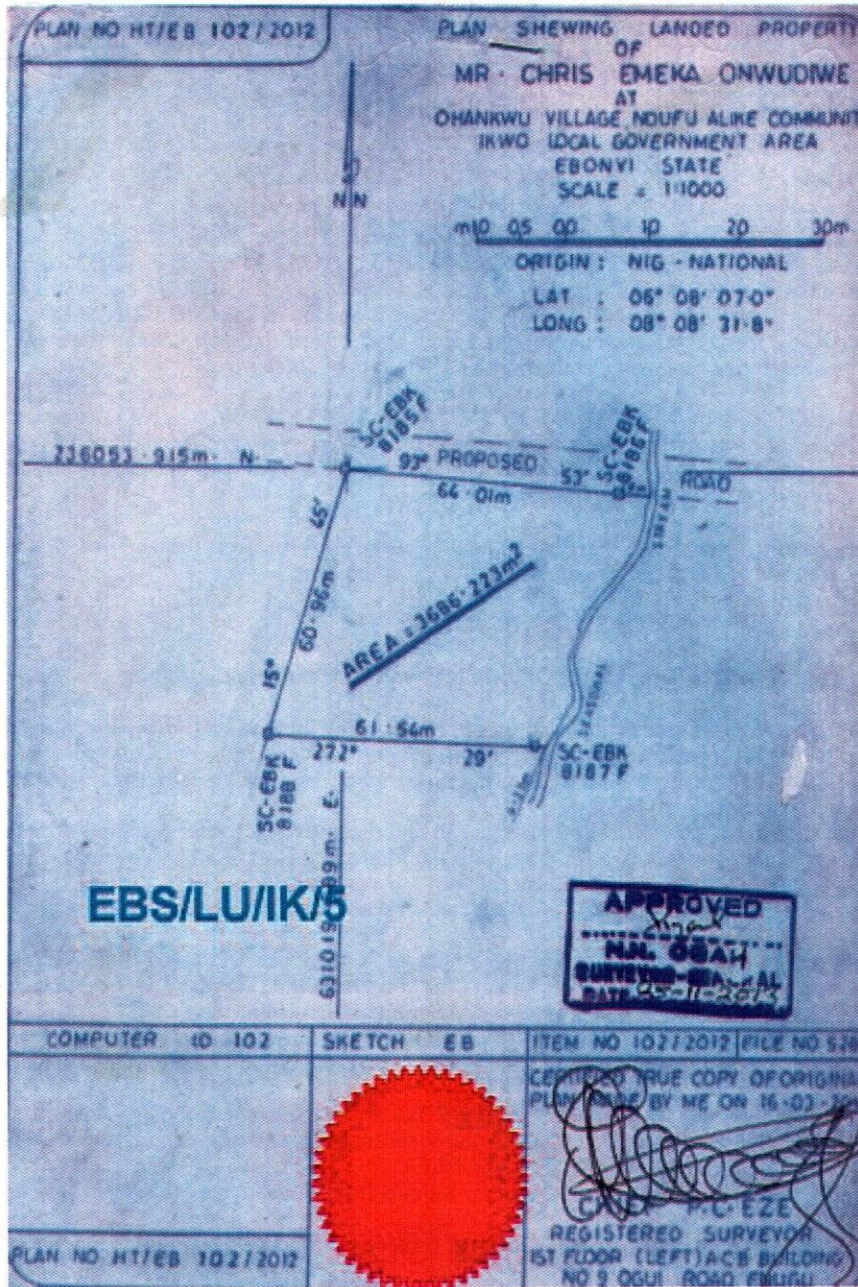

REGISTRAR
ARABIA
SIR
ENUGU

REGISTRAR
ARABIA
SIR
ENUGU

The within instrument in the opinion of the commissioner of stamp duties chargeable with the sum of N100.00 and the duty thereon has been assessed accordingly.

(sgd) Obasi B. D.

Commissioner For Stamp Duties
RCR NO 0288160 OF 19/12/13

This instrument was delivered for registration at 14:7 O'clock in the AFTERNOON on 10th April, 2014 and registered as No 13 at page 13 Volume 198 of the Ministry of Lands Registry in the Office at Abakaliki

Registrar of Deeds

CERTIFIED TRUE COPY
REGISTRAR OF DEEDS



Pal/6239
26/6/14



EBONYI LANDS INFORMATION MANAGEMENT SYSTEM



SURVEY DESCRIPTION OF LANDED PROPERTY OF PAL/6239

ONWUDIWE EMEKA CHRIS

**OHANKWU VILLAGE NDUFU ALIKE
COMMUNITY**

that parcel of land at IKWO in the

Local Government Area of the Ebonyi State of Nigeria, containing an Area of approximately

686.223 Square Metres shown on Ebonyi State of Nigeria Survey Plan No.

HT/EB 102/2012

(Tracing No. ---) the

boundaries of which are described below.

Starting at concrete pillar marked **SCEBK 8187 F** the coordinates of which are:

235992.577 Metres North and 631064.524 Metres East of a concrete pillar marked

NIG.NATIONAL the origin of **NATIONAL ZERO** cadastral surveys. The boundaries run

in straight lines the bearings and length of which are as follows:

S/N	From	Bearing		Lengths in: M		To
		Degree (°)	Minute (')	Length		
	SCEBK 8187F	272	29	61.54M		SCEBK 8188F
	SCEBK 8188F	15	45	60.96M		SCEBK 8185F
	SCEBK 8185F	93	53	64.01M		SCEBK 8186F
	SCEBK 8186F	BOUNDED BY A		SEASONAL	STREAM TO	
	SCEBK 8187F	THE		STARTING	POINT	

All property beacons are concrete pillars, all bearing and length approximate and all bearings are referred to National /True North.

FOR SURVEYOR - GENERAL
EBONYI STATE OF NIGERIA
