

Nº 0002612

May/118/14



ERSL/AL/2571

EBONYI STATE OF NIGERIA

No. 49

Vol: 288

PAGE 49

Certificate of Occupancy

LDR No:.....

File No: PAL/6706

This is to certify that OGBONNA FRANCIS NWIFURU of NO 31 EMEOFOR STREET ABAKALIKI, EBONYI STATE (hereinafter called the holder/holders) is/are granted a right of occupancy in respect of PART OF PLOTS 11 AND 12 ABANKALIKI LAYOUT ALONG IGWE-OGBOFIA STREET OHU-IGBOJI AMIKE-ABA, EBONYI LOCAL GOVERNMENT AREA, EBONYI STATE described in the Schedule and more particularly marked and delineated in the PLAN NO. HT/EB 95/2013 attached to this certificate and thereon bordered or verged RED for the term of 99 (NINETY-NINE) year(s) from the 1ST JANUARY, 2014 subject to the provision of the LAND USE ACT, 1978 and to the provisions and conditions implied by virtue of the said Act and the Regulations for the time being in force made under the said Act and to the covenants and conditions herein contained.

30/5/14

- 1(a) RENT: N1,180.00 (ONE THOUSAND ONE HUNDRED AND EIGHTY NAIRA) per annum.
- (b) The rent hereby reserved shall be revised at the end of every 5 (FIVE) year(s) of the term of this grant.
- (c) Buildings to the value of not less than N1,000,000.00 (ONE MILLION NAIRA) to the satisfaction and in accordance with plans approved by the A.P.A or such officer as the A.P.A may appoint.
- (d) Time within which such building(s) is/are to be erected and completed fit for occupation and use. Within 3 (THREE) year(s) from the date of commencement of the term of this certificate.
- (e) Purpose for which the land granted may be used: RESIDENTIAL

2. This certificate of occupancy is issued subject to the following Covenants and conditions being observed by the holder/holders:-

- (a) Not to erect or build or permit to be erected or built on the land hereby granted any buildings other than those covenanted to be erected by virtue of this certificate of occupancy and the regulations under the said Act not to make or permit to be made any addition or alteration to the said buildings to be erected except in accordance with plans and specification approved by the A.P.A of Ebonyi State of Nigeria or any other officer appointed by him.
- (b) To keep the exterior and interior of the buildings to be erected and the outbuilding and erections which may at any time during the term hereby created be erected on the land hereby granted and all additions to such buildings and outbuildings and the walls, fences and appurtenances thereof in good and tenable repair and condition.
- (c) Not to use the building on the said land whether now erected or to be erected hereafter thereon for any purpose other than that specified in these presents.
- (d) Not to alienate the right of Certificate of Occupancy hereby granted or any part thereof by sale, assignment, mortgage, transfer of possession, sublease, or bequest or otherwise howsoever without the consent of the GOVERNOR, first had and obtained.
- (e) Not to permit anything to be used or done upon any part of the granted premises which shall be noxious, noisy or offensive or be of any inconvenience or annoyance to tenants or occupiers of premises adjoining or near thereto.
- (f) To maintain standards of accommodation and sanitary and living conditions conformable with standards obtaining in the neighbourhood.
- (g) To pay forthwith with or without demand to the DIRECTOR LANDS or other persons appointed by him before the issue of this certificate, all survey fees, registration fees, and other charges due in respect of preparation and issue and registration of this certificate.
- (h) Paid an improvement premium of N00.00 (NOT APPLICABLE)
- (i) To install and operate water borne sewage system within six months from the date the buildings erected on the plot are connected to piped water-supply.
- (j) To pay with or without demand on the first day of January of each year the rent reserved in these presents or any other rent as may be revised in future.

GIVEN under my hand this 22nd day of May 2014

ARC. NWOGHA FRIDAY MOSES

COMMISSIONER FOR LANDS, SURVEY AND HOUSING EBONYI STATE OF NIGERIA

(By virtue of Powers to grant Certificate of Occupancy and Right of Occupancy delegated to him by the Governor, under Section 4(a) and (b) of the Land Use Edict (now Law) NO.2 of 1979 (as applicable in Ebonyi State), and Section 45 of the Land Use Act No.6 of 1978.

Signature of Holder / Holders Signature of Witness

Name of Witness UGWUMBA RIFA Occupation of Witness CIVIL SERVAINT

Address MINISTRY OF LANDS SURVEY AND HOUSING ABAKALIKI

30/5/14



Title Holder: OGBONNA FRANCIS NWIFURU

Old File Number: EBS/LU/AI/2571 New File Number: PAL/6706

Survey Plan No: HT/EB 95/2013

Property Description: PART OF PLOTS 11 AND 12 ABANKALIKI LAYOUT ALONG IGWE-OGBOFIA STREET OHU-IGBOJI AMIKE-ABA, EBONYI LOCAL GOVERNMENT AREA, EBONYI STATE

NIGERIA
One hundred
STAMP DUTIES

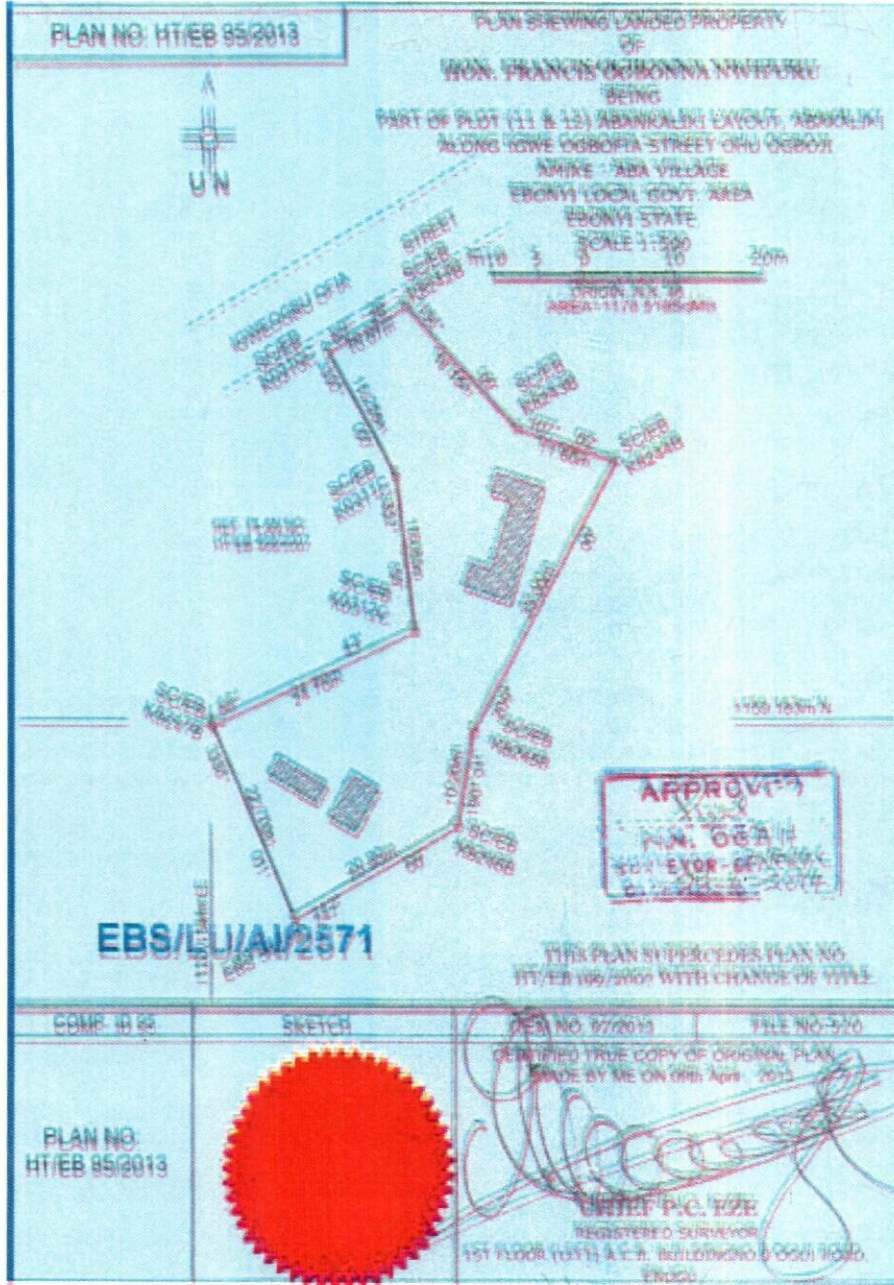

The within instrument in the opinion of the commissioner of stamp duties chargeable with the sum of N100.00 and the duty thereon has been assessed accordingly.

[Signature]
Commissioner For Stamp Duties
RCR NO 0273368 OF 13/05/2014

This instrument was delivered for registration at 14:25 O'clock in the AFTERNOON on 14th May, 2014 and registered as No 49 at page 49 Volume 288 of the Ministry of Lands Registry in the Office at Abakaliki

[Signature]
Registrar of Deeds

CERTIFIED TRUE COPY
[Signature]
REGISTRAR OF DEEDS

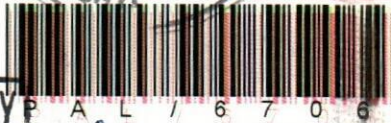

[Signature] 30/5/14



EBONYI LANDS INFORMATION MANAGEMENT SYSTEM



SURVEY DESCRIPTION OF LANDED PROPERTY OF

HON. FRANCIS OGBONNA NWIFURU

All that parcel of land at PLOT 11 & 12 ABANKALIKI LAYOUT in the EBONYI Local Government Area of the Ebonyi State of Nigeria, containing an area of approximately 1178.519 Square Meters shown on Ebonyi State of Nigeria Survey Plan No. HT/EB 95/13 (Tracing No:) the boundaries of which are described below.

Starting at concrete pillar marked SC/EBK 8247B, the coordinates of which are: 1159.183 Meters North and 1120.154 Meter East of a concrete pillar marked NK 48 the origin of ABAKALIKI Cadastral surveys. The boundaries run in straight lines the bearings and lengths of which are as follows:

S/N	From	Bearing		Lengths in: M	
		Degree(°)	Minute(')	Length	To
	SC/EBK8247B	66°	43'	24.70m	SC/EBK0312C
	SC/EBK0312C	352°	59'	16.65m	Sc/EBK0311C
	SC/EBK0311C	330°	00'	15.25m	SC/EBK0310C
	SC/EBK0310C	60°	26'	10.07m	SC/EBK8242B
	SC/EBK8242B	136°	09'	18.15m	SC/EBK8243B
	SC/EBK8243B	107°	02'	11.60m	SC/EBK8244B
	SC/EBK8244B	209°	00'	33.00m	SC/EBK8245B
	SC/EBK8245B	190°	01'	10.20m	SC/EBK8246B
	SC/EBK8246B	242°	00'	20.90m	EBS 5414B
	EBS 5414B	336°	01'	22.70m	SC/EBK8247B
			THE	STARTING	POINT

All property beacons are concrete pillars, all bearings and lengths approximate and all bearings are referred to National/True North.

[Signature]
 For Surveyor-General
 Ebonyi State of Nigeria
