

No 77
Nº 0001462

Vol 219



PAGE 77 PAL/3294

July/16/2012

EBONYI STATE OF NIGERIA
EBS/LU/Al/1955.

Al SUR/NO/198/5/2013/CBSG.

Certificate of Occupancy

LDR No:.....

File No: PAL/3294

This is to certify that **NWITE CHUKWUMA BENJAMIN** of **NO 16 IDEATO STREET, AWADA LAYOUT ONITSHA, ANAMBRA STATE** (hereinafter called the holder/holders) is/are granted a right of occupancy in respect of **PLOT AT NDIONUEGU NTEZI-ABA VILLAGE EBONYI LOCAL GOVERNMENT, EBONYI STATE** described in the Schedule and more particularly marked and delineated in the **PLAN NO. HT/EB 225/2004** attached to this certificate and thereon bordered or verged **RED** for the term of **99 (NINETY-NINE)** year(s) from the **1ST JANUARY, 2012** subject to the provision of the **LAND USE ACT, 1978** and to the provisions and conditions implied by virtue of the said Act and the Regulations for the time being in force made under the said Act and to the covenants and conditions herein contained.

23/2/015

- 1(a) RENT: **N956.00 (NINE HUNDRED AND FIFTY- SIX NAIRA)** per annum.
- (b) The rent hereby reserved shall be revised at the end of every **5 (FIVE)** year(s) of the term of this grant.
- (c) Buildings to the value of not less than **N1,000,000.00 (ONE MILLION NAIRA)** to the satisfaction and in accordance with plans approved by the **A.P.A** or such officer as the **A.P.A** may appoint.
- (d) Time within which such building(s) is/are to be erected and completed fit for occupation and use. Within **3 (THREE)** year(s) from the date of commencement of the term of this certificate.
- (e) Purpose for which the land granted may be used: **RESIDENTIAL**

2. This certificate of occupancy is issued subject to the following Covenants and conditions being observed by the holder/holders:-

- (a) Not to erect or build or permit to be erected or built on the land hereby granted any buildings other than those covenanted to be erected by virtue of this certificate of occupancy and the regulations under the said Act not to make or permit to be made any addition or alteration to the said buildings to be erected except in accordance with plans and specification approved by the **A.P.A** of Ebonyi State of Nigeria or any other officer appointed by him.
- (b) To keep the exterior and interior of the buildings to be erected and the outbuilding and erections which may at any time during the term hereby created be erected on the land hereby granted and all additions to such buildings and outbuildings and the walls, fences and appurtenances thereof in good and tenantable repair and condition.
- (c) Not to use the building on the said land whether now erected hereafter thereon for any purpose other than
- (d) Not to alienate the right of Certificate of Occupancy hereby granted or any part thereof by sale, assignment, mortgage, transfer of possession, sublease, or bequest or otherwise howsoever without the consent of the **GOVERNOR** first had and obtained.
- (e) Not to permit anything to be used or done upon any part of the granted premises which shall be noxious, noisy or offensive or be of any inconvenience or annoyance to tenants or occupiers of premises adjoining or near thereto.
- (f) To maintain standards of accommodation and sanitary and living conditions conformable with standards obtaining in the neighbourhood.
- (g) To pay forthwith with or without demand to the **DEPUTY DIRECTOR LAND** or other persons appointed by him before the issue of this certificate, all survey fees, registration fees, and other charges due in respect of preparation and issue and registration of this certificate.
- (h) Paid an improvement premium of **N00.00 (NOT APPLICABLE)**
- (i) To install and operate water borne sewage system within six months from the date the buildings erected on the plot are connected to piped water-supply.
- (j) To pay with or without demand on the first day of January of each year the rent reserved in these presents or any other rent as may be revised in future.

GIVEN under my hand this 4th day of February 2013

ARC. NWOGHA FRIDAY MOSES

COMMISSIONER FOR LANDS, SURVEY AND HOUSING EBONYI STATE OF NIGERIA

(By virtue of Powers to grant Certificate of Occupancy and Right of Occupancy delegated to him by the Governor, under Section 4(a) and (b) of the Land Use Edict (now Law) N0.2 of 1979 (as applicable in Ebonyi State), and Section 45 of the Land Use Act No.6 of 1978.

Signature of Holder / Holders Signature of Witness

Name of Witness UGWUMBA RITA Occupation of Witness CIVIL SERVANT

Address MINISTRY OF LANDS SURVEY AND HOUSING ABAKALIKI

5/2/015.



Title Holder: NWITE CHUKWUMA BENJAMIN

Old File Number: EBS/LU/AI/1955 New File Number: PAL/3294

Survey Plan No: HT/EB 225/2004

Property Description: PLOT AT NDIONUEGU NTEZI-ABA VILLAGE EBONYI LOCAL GOVERNMENT, EBONYI STATE

One hundred names
NIGERIA
STAMP DUTIES

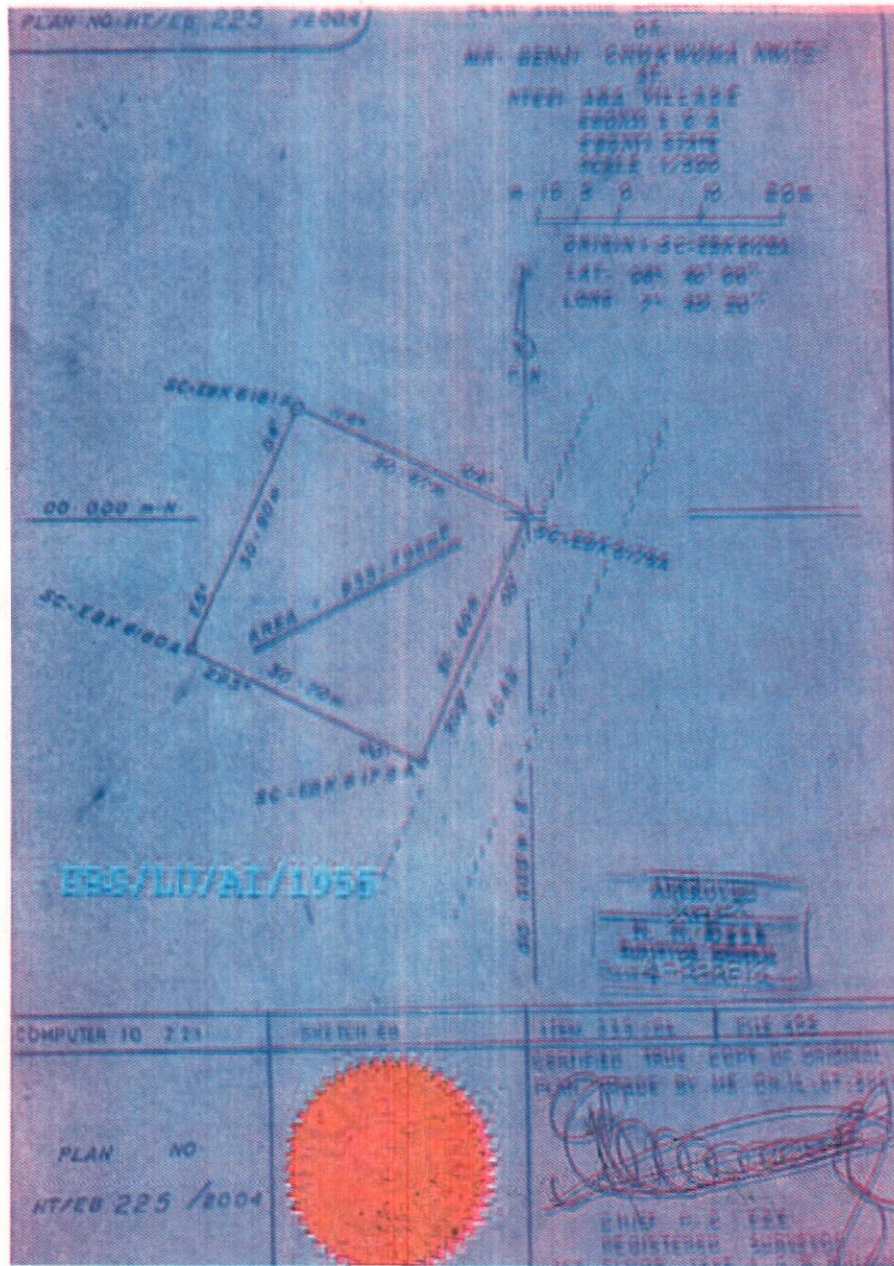

The within instrument in the opinion of the commissioner of stamp duties chargeable with the sum of N100.00 and the duty thereon has been assessed accordingly.

(Sgd) *Obasi B O*
Commissioner For Stamp Duties
RCR NO 0167966 OF 14/06/012

This instrument was delivered for registration at 13:18 O'Clock in the AFTERNOON on 26th July, 2012 and registered as No 77 at page 77 Volume 219 of the Ministry of Lands Registry in the Office at Abakaliki

[Signature]
Registrar of Deeds



CERTIFY COPY
[Signature]
REGISTRAR OF DEEDS

Benjamin
6/2/015



SURVEY DESCRIPTION OF LANDED PROPERTY OF PAL/3294

BENJAMIN CHUKWUMA NWITE

NDIONUEGU NTEZI-ABA VILLAGE

in the EBONYI



All that parcel of land at _____ in the _____

Local Government Area of the Ebonyi State of Nigeria, containing an Area of approximately

Square Metres shown on Ebonyi State of Nigeria Survey Plan No.

HT/EB225/2004

(Tracing No. _____) the

boundaries of which are described below.

Starting at concrete pillar marked SC-EBK6178A the coordinates of which are:

0.000 Metres North and 0.000 Metres East of a concrete pillar marked

SCEBK6178A the origin of LOCALLY BASED cadastral surveys. The boundaries run

in straight lines the bearings and lengths of which are as follows:

S/N	From	Bearing		Lengths in: M		To
		Degree (°)	Minute (')	Length		
	SCEBK6178A	205	00	31.40		SCEBK6179A
	SCEBK6179A	295	00	30.70		SCEBK6180A
	SCEBK6180A	25	04	30.90		SCEBK6181A
	SCEBK6181A	114	04	30.67		SCEBK6178A
THE STARTING POINT						

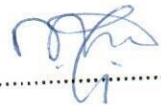

All property beacons are concrete pillars, all bearings and lengths approximate and all bearings are referred to Colony /True North.

for Surveyor-General
Ebonyi State of Nigeria
